

The Cape Fear Rural Transportation Planning Organization exists to serve as the intergovernmental organization for local elected officials, the North Carolina Department of Transportation, and residents of Brunswick, Columbus, and Pender Counties to work cooperatively to address transportation issues.

Rural Transportation Coordinating Committee (RTCC)

Meeting Agenda

October 2, 2024 • 10:30 AM

Meeting via Zoom

[Join meeting](#)

Join by phone: (929) 205-6099

Meeting ID: 869 0543 2491

Meeting passcode: 590743

I. INTRODUCTORY BUSINESS

1. Call to Order
2. Roll Call
3. Additions or Corrections to the Agenda
4. Approval of Minutes: August 7, 2024 [*attached*] (pages 3-6 in the PDF)
5. Public Comment
6. Vacancies and Appointments [*attached*] (page 7 in the PDF)

II. PRESENTATIONS

There are no scheduled presentations.

III. REGULAR BUSINESS

7. **P7.0 Division Needs Local Input Points** – The P7.0 Division Needs Local Input Point assignment window is from Monday, September 23rd through Friday, November 29th. RPO staff, with assistance from NCDOT and RPO members, has evaluated projects according to the Local Input Point methodology approved by NCDOT and the Cape Fear RTAC in April 2024. *Staff requests a motion to recommend local input point assignments to the RTAC for their approval (pages 8-22 in the PDF).*

8. **2025 Cape Fear RPO Meeting Schedule** – Proposed dates for the 2024 Cape Fear RPO RTCC and RTAC meetings. *Staff requests a motion to recommend approval of the attached meeting schedule to the RTAC (page 23 in the PDF).*

9. **Reports/Updates**

- Cape Fear RPO (page 24 in the PDF)
- NC Ports (Port of Wilmington)
- NC Ferry (Fort Fisher to Southport)
- NCDOT Division 3 (Brunswick & Pender) (pages 25-28 in the PDF)
- NCDOT Division 6 (Columbus) (pages 29-42 in the PDF)
- NCDOT Transportation Planning Division (TPD) (pages 43-44 in the PDF)
- NCDOT Integrated Mobility Division (IMD)
- Wilmington Area MPO (WMPO)
- Grand Strand MPO (GSATS)

IV. OTHER

10. **Open discussion:** General questions, comments, and other discussions

11. **Adjourn**

The Cape Fear Rural Transportation Planning Organization exists to serve as the intergovernmental organization for local elected officials, the North Carolina Department of Transportation, and residents of Brunswick, Columbus, and Pender Counties to work cooperatively to address transportation issues.

Rural Transportation Coordinating Committee (RTCC) Meeting Minutes August 7, 2024 • 10:30 AM Held virtually via Zoom

Voting Members Present

Helen Bunch, Brunswick County
Mo Meehan, Southport
Jeff Repp, Saint James
Dylan Bowen, Columbus County
Robert Lewis, Whiteville
Adam Moran, Pender County
Amy Kimes, Surf City

Ron Meredith, Burgaw
Michelle Howes, NCDOT Division 3
Philip Hart, NCDOT Division 6
Hemal Shah, NCDOT TPD
Greer Shivers, WMPO
Sam Boswell, Cape Fear RPO

Others Present

Nicole Morgan, Boiling Spring Lakes
Doug Shipley, Topsail Beach
Mel Miller, Sandy Creek
Sabra Child, Sandy Creek

Ken Clark, NCDOT Div. 6, District 3
Bill Hammond, NCDOT Division 6
Kim Nguyen, NCDOT IMD
Michael Raynor, NCDOT TPD

I. INTRODUCTORY BUSINESS

- 1. Call to Order** – The meeting was held via video conference on Zoom. Having reached a quorum, Sam Boswell called the meeting to order at 10:30 AM.
- 2. Roll Call** – A roll call was taken of attendees.
- 3. Additions or Corrections to the Agenda** – There were no changes made to the agenda. *Helen Bunch made a motion to approve the agenda. Mo Meehan seconded the motion. A roll call vote was taken.*

*Helen Bunch, Yes
Mo Meehan, Yes
Jeff Repp, Yes
Dylan Bowen, Yes
Robert Lewis, Yes*

*Adam Moran, Yes
Amy Kimes, Yes
Ron Meredith, Yes
Michelle Howes, Yes
Philip Hart, Yes*

*Hemal Shah, Yes
Greer Shivers, Yes
Sam Boswell, Yes*

The motion passed unanimously.

4. **Approval of Minutes** – The minutes of the June 5, 2024, RTCC meeting were presented. *Mo Meehan made a motion to approve the minutes. Robert Lewis seconded the motion. A roll call vote was taken.*

*Helen Bunch, Yes
Mo Meehan, Yes
Jeff Repp, Yes
Dylan Bowen, Yes
Robert Lewis, Yes*

*Adam Moran, Yes
Amy Kimes, Yes
Ron Meredith, Yes
Michelle Howes, Yes
Philip Hart, Yes*

*Hemal Shah, Yes
Greer Shivers, Yes
Sam Boswell, Yes*

The motion passed unanimously.

5. **Public Comment** – There were no comments from the public.

II. PRESENTATIONS

There were no scheduled presentations for this meeting.

III. REGULAR BUSINESS

6. **P7.0 Regional Impact Local Input Points** – The P7.0 Regional Impact Local Input Point assignment window is from Tuesday, May 28th through Friday, August 30th. RPO staff, with assistance from NCDOT and RPO members, has evaluated projects according to the Local Input Point methodology approved by NCDOT and the Cape Fear RTAC in April 2024.

RPO staff presented the results of the methodology and discussed draft point assignments with the RTCC. Nicole Morgan expressed a desire for local input points to be placed on H230501 – adding turn lanes to NC 87 between Fifty Lakes Drive and S Shore Drive. She proposed that the 81 points preliminarily assigned to H183735 be moved to H230501. This would allow the RPO to place points on an important NC 87 improvement without jeopardizing improvements to NC 211. The improvements included in H183735 are already accounted for the better-scoring projects H090806-A and H090806-C, which are higher on the RPO’s list for point assignments. After being assured that this proposed change would not compromise point assignments to the NC 211 corridor, the committee had no further questions.

Adam Moran made a motion to recommend approval of the adjusted point assignments to the RTAC, and Helen Bunch seconded the motion. A roll call vote was taken.

*Helen Bunch, Yes
Mo Meehan, Yes
Jeff Repp, Yes
Dylan Bowen, Yes
Robert Lewis, Yes*

*Adam Moran, Yes
Amy Kimes, Yes
Ron Meredith, Yes
Michelle Howes, Yes
Philip Hart, Yes*

*Hemal Shah, Yes
Greer Shivers, Yes
Sam Boswell, Yes*

The motion passed unanimously.

The Cape Fear Rural Transportation Planning Organization exists to serve as the intergovernmental organization for local elected officials, the North Carolina Department of Transportation, and residents of Brunswick, Columbus, and Pender Counties to work cooperatively to address transportation issues.

7. **Priorities of Existing Committed Projects** – As part of the development of the 2026-2035 Draft STIP, NCDOT is seeking input from Planning Organizations and Divisions on priorities of existing committed projects. These projects have previously been selected for funding through Prioritization cycles 3.0, 4.0, and 5.0. This input will be used to assist the STIP Unit when adjusting schedules to meet federal and state fiscal restraint requirements.

Amy Kimes informed the committee that Surf City would prefer to rank R-5900 ahead of R-5899 given the scope of each project and the momentum they have with developers who are working with the Town on delivering R-5900. Doug Shipley agreed that R-5900 offered a wider range of benefits to the Surf City/Topsail Beach area and supported Amy's recommendation to swap the priority of those two projects. There were no other questions from the committee.

Amy Kimes made a motion to recommend reprioritizing committed projects R-5900 and R-5899 (placing R-5900 ahead of R-5899 instead of relying on NCDOT's Seniority Approach), and Adam Moran seconded the motion. A roll call vote was taken.

*Helen Bunch, Yes
Mo Meehan, Yes
Jeff Repp, Yes
Dylan Bowen, Yes
Robert Lewis, Yes*

*Adam Moran, Yes
Amy Kimes, Yes
Ron Meredith, Yes
Michelle Howes, Yes
Philip Hart, Yes*

*Hemal Shah, Yes
Greer Shivers, Yes
Sam Boswell, Yes*

The motion passed unanimously.

8. **Resolutions of Support: 5310 Grant Applications** – Monarch and Columbus County Transportation have requested resolutions of support for their applications for FTA 5310 grant funds. *Robert Lewis made a motion to recommend approval of the resolutions of support to the RTAC, and Dylan Bowen seconded the motion. A roll call vote was taken.*

*Helen Bunch, Yes
Mo Meehan, Yes
Jeff Repp, Yes
Dylan Bowen, Yes
Robert Lewis, Yes*

*Adam Moran, Yes
Amy Kimes, Yes
Ron Meredith, Yes
Michelle Howes, Yes
Philip Hart, Yes*

*Hemal Shah, Yes
Greer Shivers, Yes
Sam Boswell, Yes*

The motion passed unanimously.

IV. REPORTS/UPDATES

9. Reports/Updates

- **Cape Fear RPO:** Staff provided updates on the revisions to the 2024-2033 STIP. Staff announced that Oak Island and Southport were both awarded planning grants from their applications to IMD's Multimodal Planning Grant program earlier this year. Staff reminded RTCC members that the Pender County CTP public survey remains open through September 1st.
- **NC Ports:** There were no updates from the Ports.
- **Ferry Division:** There were no updates from the Ferry Division.
- **NCDOT Division 3 (Brunswick & Pender):** Michelle Howes gave Division 3 updates.
- **NCDOT Division 6 (Columbus):** Philip Hart gave Division 6 updates.
- **NCDOT Transportation Planning Division (TPD):** Hemal Shah gave updates on the Brunswick, Columbus, and Pender County CTPs.
- **NCDOT Integrated Mobility Division (IMD):** Kim Nguyen gave IMD updates.
- **Wilmington Area MPO (WMPO):** Greer Shivers provided WMPO updates.
- **Grand Strand MPO (GSATS):** There were no updates from GSATS.

IV. OTHER

10. **Open discussion** – There was no additional discussion.

11. **Adjourn** – *The meeting was adjourned at 11:40 AM.*

The Cape Fear Rural Transportation Planning Organization serves as the intergovernmental organization for local elected officials, the North Carolina Department of Transportation, and residents of Brunswick, Columbus, and Pender Counties to work cooperatively to address transportation issues.

Cape Fear RPO: RTCC County & Municipal Voting Members			
SEAT	TERM	NAME	POSITION
Brunswick County		Helen Bunch	Planner III
Brunswick County Alt.		Marc Pages	Land Planner
Brunswick Municipal 1	2024-2025	Mo Meehan	Southport
Brunswick Municipal 2	2023-2024	Jeff Repp	St. James
Brunswick Municipal Alt. 1	2024-2025	Nicole Morgan	Boiling Spring Lakes
Brunswick Municipal Alt. 2	2023-2024	Matt Kirkland	Oak Island
Columbus County		Gary Lanier	Economic Development Director
Columbus County Alt.		Dylan Bowen	Economic Development Specialist
Columbus Municipal 1	2023-2024	Robert Lewis	Whiteville
Columbus Municipal 2	2023-2024	Jason Robinson	Chadbourn
Columbus Municipal Alt. 1	2023-2024	Damon Kempfski	Lake Waccamaw
Columbus Municipal Alt. 2	2024-2025	Madison Ward	Whiteville EDC
Pender County		Adam Moran	Long Range Planner
Pender County Alt.		Justin Brantley	Deputy Planning Director
Pender Municipal 1	2023-2024	Amy Kimes	Surf City
Pender Municipal 2	2024-2025	Ron Meredith	Burgaw
Pender Municipal Alt. 1	2023-2024	Doug Shipley	Topsail Beach
Pender Municipal Alt. 2	2024-2025	Rob Taylor	Wallace

Procedures for Municipal Alternates' Participation in RTCC Meetings:

Alternate 1 will serve as voting member if Voting 1 is absent OR if both Voting 2 and Alternate 2 are absent.

Alternate 2 will serve as voting member if Voting 2 is absent OR if both Voting 1 and Alternate 1 are absent.

The Cape Fear Rural Transportation Planning Organization serves as the intergovernmental organization for local elected officials, the North Carolina Department of Transportation, and residents of Brunswick, Columbus and Pender Counties to work cooperatively to address transportation issues.

MEMORANDUM

DATE: October 1, 2024
TO: Cape Fear RTCC Members
FROM: Sam Boswell, Cape Fear RPO
RE: Division Needs Local Input Point Preliminary Assignments

On April 12, 2024, the Cape Fear RPO Rural Transportation Advisory Committee (RTAC) adopted the official methodology for assigning local input points to projects competing for funding in Prioritization 7.0 (P7.0). Following this methodology, the Cape Fear RPO approved local input points for projects in the Regional Impact funding category during its August 2024 RTCC and RTAC meetings. RPO Staff has now worked through the approved methodology to assign preliminary points to projects eligible in the Division Needs funding category.

The following are the four criteria RPO staff used to rank eligible projects for preliminary points:

1. **Prioritization 7.0 Quantitative Score:** The P7.0 Score is the best criterion to maximize the funding potential of the transportation projects in the RPO area.
2. **Division Priority:** Projects will not be competitive unless they have the support of the Division Engineer and rank well by the Division Engineer's scoring criteria.
3. **County Priority:** Projects should have local support. RPO Staff coordinated with RTCC and RTAC members in each county to determine the local priority of eligible P7.0 projects.
4. **Project Development:** Projects that have had significant planning or development activities completed are eligible for additional points to distinguish them from projects that are simply conceptual.

After using the above criteria to formulate project rankings for the eligible Division Needs projects, RPO Staff assigned preliminary points to the highest-ranking projects. Preliminary points were assigned until all 1300 available points were allocated as follows:

1. The top two scoring highway projects in each RPO county will be eligible for 100 points each (600 points max).
2. The top three scoring non-highway projects will be eligible for 100 points each, regardless of non-highway mode or location (300 points max).

3. Remaining points cascade to the next highest scoring projects, regardless of mode or location, up to 100 points each.

Listed below are the preliminary point assignments based on the RPO’s point assignment methodology. This list is to be reviewed by both the RTCC and RTAC before submission to NCDOT. Deviations from the methodology are acceptable so long as justifications are adequately recorded. A full summary of eligible projects and their ranking score is available on the RPO’s Project Prioritization webpage.

Table 1a. Brunswick County Top 2 Highway Projects			
SPOT ID	Description	Cost to NCDOT	Preliminary Points
H090806-C	Widen NC 211 to 4 lanes from Sunset Harbor Rd (SR 1112) to Midway Rd (NC 906).	\$ 64,500,000	100
H090287-AG	Upgrade US 74/76 to interstate standards from NC 87 (Maco Rd) to SR 1426 (Mount Misery Rd).	\$ 68,300,000	100 ¹

Table 1b. Columbus County Top 2 Highway Projects			
SPOT ID	Description	Cost to NCDOT	Preliminary Points
H090287-H	US 74 and SR 1800 (Blacksmith Rd) - Convert at-grade intersection to grade separation. Formerly H150987.	\$ 9,000,000	100
H170044	Construct roundabout at intersection of NC 410 and US 74/76 Business (E Strawberry Blvd).	\$ 4,700,000	100

Table 1c. Pender County Top 2 Highway Projects			
SPOT ID	Description	Cost to NCDOT	Preliminary Points
H190898	Modernize US 117 from Porters Lane Rd (SR 1416) to S Walker St.	\$ 44,400,000	100
H190471	Convert Grade Separation of I-40 and SR 1412 (New Road) to an Interchange to relieve existing congestion of I-40 and NC 210 interchange.	\$ 8,600,000	100

¹ This project is 11% in the Cape Fear RPO and 89% in the Wilmington MPO. The RPO can choose to only assign 11 points or to assign the full 100, which would include donating 89 points to the WMPO.

Table 2. Cape Fear RPO Top 3 Non-Highway Projects			
SPOT ID	Description	Cost to NCDOT	Preliminary Points
A191565	CPC (Columbus Co. Municipal) - Runway extension of Runway #6.	\$ 3,925,000	100
A170437	CPC (Columbus Co. Municipal) - Widen and lengthen runway safety area, widen runway, and install an approach lighting system.	\$ 10,536,000	100
A191821	SUT (Cape Fear Regional Jetport) - Strengthen the existing runway to support 500 annual departures of a Gulfstream 650 as the critical aircraft.	\$ 8,750,000	100

Table 3. Cape Fear RPO Top Remaining Eligible Projects			
SPOT ID	Description	Cost to NCDOT	Preliminary Points
F192751	Replace the aging synchro-lift at Manns Harbor Shipyard to increase reliability and ensure haul out capabilities.	\$ 3,000,000	20 ²
H090806-A	Widen NC 211 to 4 lanes from US 17 in Supply to SR 1112 (Sunset Harbor Rd) per Feasibility Study WS-40814.	\$ 214,500,000	100 ³
A191621	ACZ (Henderson Field) - Design and construct the eastern partial parallel taxiway that will connect to the end of Runway 27 and to the east edge of the existing terminal area apron.	\$ 3,061,000	100
H090287-G	US 74/76 and NC 87 (Maco Road) - Upgrade at-grade intersection to interchange.	\$ 69,800,000	100
A230640	ACZ (Henderson Field) - Upgrade and expand existing apron for aircraft parking.	\$ 8,661,000	80 ⁴

² This is the full share of points from the Cape Fear RPO. Other planning organizations associated with the Ferry Division are eligible to submit their share of points to this project.

³ This project is 92% in the Cape Fear RPO and 8% in the GSATS MPO. The RPO can choose to only assign 92 points or to assign the full 100, which would include donating 8 points to GSATS.

⁴ This point total is the remainder of the RPO's allotted 1300 points.

P7.0 DIVISION NEEDS Local Input Points: Preliminary Point Assignments

SPOT ID	Project Category	Project Mode	Project Description	Cost to NCDOT	Division	County	CFRPO Share	P7.0 Division Needs Score -- 30% --	Division Priority -- 30% --	County Priority -- 30% --	Project Development -- 10% --	Ranking Score	Division Needs Preliminary Points	Comments		
H090806-C	Regional Impact	Highway	Widen NC 211 to 4 lanes from SR 1112 (Sunset Harbor Road) to NC 906 (Midway Road) per feasibility study WS-40814.	\$ 64,500,000	3	Brunswick	100	29.00	High	100	High	100	90	77.70	100	#1 Brunswick County Highway TIP: R-5947; Regional Points: 100
H090287-AG	Statewide Mobility	Highway	Upgrade US 74/76 to interstate standards from NC 87 (Maco Rd) to SR 1426 (Mount Misery Rd).	\$ 68,300,000	3	Brunswick	11	33.02	High	100	High	100	40	73.91	100	#2 Brunswick County Highway TIP: R-4462; 89% WMPO Regional Points: 11 from WMPO
A191565	Division Needs	Aviation	CPC (Columbus Co. Municipal) - Runway extension of Runway #6.	\$ 3,925,000	6	Columbus	100	41.89	High	100	High	100	10	73.57	100	#1 Non-Highway
A170437	Division Needs	Aviation	CPC (Columbus Co. Municipal) - Widen and lengthen runway safety area, widen runway, and install an approach lighting system.	\$ 10,536,000	6	Columbus	100	40.13	High	100	High	100	10	73.04	100	#2 Non-Highway
A191821	Division Needs	Aviation	SUT (Cape Fear Regional Jetport) - Strengthen the existing runway to support 500 annual departures of a Gulfstream 650 as the critical aircraft.	\$ 8,750,000	3	Brunswick	100	39.87	High	100	High	100	10	72.96	100	#3 Non-Highway
F192751	Regional Impact	Ferry	Replace the aging synchro-lift at Manns Harbor Shipyard to increase reliability and ensure haul out capabilities.	\$ 3,000,000	1, 2, 3	Currituck, Dare, Hyde, Beaufort, Pamlico, Craven, Carteret, Brunswick, New Hanover	20	35.77	High	100	High	100	20	72.73	20	#1 Other 80% in 4 Others
H090806-A	Regional Impact	Highway	Widen NC 211 to 4 lanes from US 17 in Supply to SR 1112 (Sunset Harbor Rd) per Feasibility Study WS-40814.	\$ 214,500,000	3	Brunswick	92	28.61	High	100	High	100	40	72.58	100	#2 Other 8% GSATS; Regional Points: 92
A191621	Division Needs	Aviation	ACZ (Henderson Field) - Design and construct the eastern partial parallel taxiway that will connect to the end of Runway 27 and to the east edge of the existing terminal area apron.	\$ 3,061,000	3	Pender	100	38.29	High	100	High	100	10	72.49	100	#3 Other
H090287-G	Statewide Mobility	Highway	US 74/76 and NC 87 (Maco Road) - Upgrade at-grade intersection to interchange.	\$ 69,800,000	3	Brunswick	100	24.24	High	100	High	100	50	72.27	100	#4 Other TIP: R-4462; Regional Points: 100
A230640	Division Needs	Aviation	ACZ (Henderson Field) - Upgrade and expand existing apron for aircraft parking.	\$ 8,661,000	3	Pender	100	34.58	High	100	High	100	10	71.37	80	#5 Other TIP: AV-5815
H090287-H	Statewide Mobility	Highway	US 74 and SR 1800 (Blacksmith Rd) - Convert at-grade intersection to grade separation. Formerly H150987.	\$ 9,000,000	6	Columbus	100	23.93	High	100	High	100	40	71.18	100	#1 Columbus County Highway TIP: R-4462; Regional Points: 100
A230633	Division Needs	Aviation	CPC (Columbus Co. Municipal) - Construct corporate box hangars and taxilane.	\$ 2,648,000	6	Columbus	100	29.79	High	100	High	100	20	70.94	0	#6 Other
H170044	Regional Impact	Highway	Construct roundabout at intersection of NC 410 and US 74/76 Busines (E Strawberry Blvd).	\$ 4,700,000	6	Columbus	100	29.16	High	100	High	100	20	70.75	100	#2 Columbus County Highway
A191566	Division Needs	Aviation	CPC (Columbus Co. Municipal) - Construct perimeter fencing to increase safety and reduce wildlife inundation.	\$ 2,900,100	6	Columbus	100	28.83	High	100	High	100	20	70.65	0	#7 Other
B230582	Division Needs	Bicycle & Pedestrian	Construct multi-use path along SR 1190 (E Oak Island Dr) from NE 46th St to NE 64th St as recommended in East Coast Greenway NC 211 Feasibility Study.	\$ 2,565,600	3	Brunswick	100	28.09	High	100	High	100	10	69.43	0	#8 Other
B150520	Division Needs	Bicycle & Pedestrian	Construct on-road bike lanes on Penderlea Hwy from W Bridgers St to Burgaw municipal limits.	\$ 675,000	3	Pender	100	27.39	High	100	High	100	10	69.22	0	#9 Other
B191634	Division Needs	Bicycle & Pedestrian	Construct multi-use path on NC 87 in Boiling Spring Lakes from City Hall to the Community Center.	\$ 1,111,200	3	Brunswick	100	27.21	High	100	High	100	10	69.16	0	#10 Other
B230539	Division Needs	Bicycle & Pedestrian	Construct sidewalk in Southport along W 9th St from NC 211 (N Howe St) to Maple Ave (Southport Elem. School).	\$ 916,400	3	Brunswick	100	25.26	High	100	High	100	10	68.58	0	#11 Other
B230762	Division Needs	Bicycle & Pedestrian	Construct multi-use path along N Shore Drive in Surf City from SR 1598 (Roland Ave) to Dolphin St.	\$ 2,525,800	3	Pender	100	24.96	High	100	High	100	10	68.49	0	#12 Other
H190898	Statewide Mobility	Highway	Modernize US 117 from Porters Lane Rd (SR 1416) to S Walker St.	\$ 44,400,000	3	Pender	100	28.27	High	100	High	100	0	68.48	100	#1 Pender County Highway Regional Points: 100
H184205	Regional Impact	Highway	Widen US 701 Bypass to a 4-lane superstreet from R-5952 at SR 1503 (Complex St) to US 701 Business/NC 410 (E 5th St) in Tabor City.	\$ 40,000,000	6	Columbus	100	21.58	High	100	High	100	20	68.47	0	#13 Other Regional Points: 100

H140841	Statewide Mobility	Highway	Convert Intersection of US 17 and NC 211 to Interchange.	\$ 86,700,000	3	Brunswick	59	25.41	High	100	Med	75	70	67.12	0	#14 Other TIP: U-5932; 41% GSATS Regional Points: 59
F230649	Regional Impact	Ferry	Additional Ramp and Gantry system at Southport to expand capacity.	\$ 25,900,875	3	Brunswick, New Hanover	50	31.67	High	100	Med	75	20	64.00	0	#15 Other 50% WMPO Regional Points: 100 (50 Donated)
H190471	Division Needs	Highway	Convert Grade Separation of I-40 and SR 1412 (New Road) to an Interchange to relieve existing congestion of I-40 and NC 210 interchange.	\$ 8,600,000	3	Pender	100	6.38	High	100	High	100	10	62.91	100	#2 Pender County Highway
H090287-AF	Statewide Mobility	Highway	Upgrade US 74/76 to interstate standards from east of the Columbus / Brunswick County line to NC 87 (Maco Rd).	\$ 85,400,000	3	Brunswick	100	20.36	High	100	Med	75	40	62.61	0	TIP: R-4462 Regional Points: 100
F150235	Regional Impact	Ferry	Construct a new and additional River Class vessel - Southport-Ft. Fisher route.	\$ 25,768,160	3	Brunswick, New Hanover	50	35.13	Med	50	High	100	70	62.54	0	TIP: F-5705; 50% WMPO Regional Points: 50 from WMPO
H090803-F	Statewide Mobility	Highway	Intersection improvements at US 17 and NC 210 in Surf City.	\$ 12,700,000	3	Pender	93	22.39	High	100	Med	75	30	62.22	0	TIP: R-5877
R191557	Statewide Mobility	Rail	Construct grade separation of NC 11 (General Howe Rd) and closure of existing at-grade crossing (Crossing # 631 482U) near Sandyfield.	\$ 15,100,000	6	Columbus	100	25.92	High	100	Med	75	10	61.28	0	
H230802	Statewide Mobility	Highway	Access management along the NC 50 (Roland Ave) / NC 210 corridor from Shephards Rd to NC 50 (S Topsail Dr) / NC 210 (N New River Dr), and add slip lane at roundabout on the island.	\$ 59,100,000	3	Pender	100	24.65	High	100	Med	75	0	59.90	0	
H090805	Regional Impact	Highway	Modernize NC 53 in Burgaw from US 117 Bypass to SR 1400 (Smith St) and construct streetscape improvements per the NC 53 Corridor Study.	\$ 22,000,000	3	Pender	100	24.84	Med	50	High	100	30	55.45	0	
H090936-A	Statewide Mobility	Highway	Upgrade US 74 to interstate standards from NC 41 (near Lumberton) to US 76 (near Chadbourne).	\$ 257,000,000	6	Columbus, Robeson	52	21.89	Med	50	Med	75	100	54.07	0	TIP: I-6011; 48% LRRPO Regional Points: 52
A170438	Division Needs	Aviation	CPC (Columbus Co. Municipal) - Construct one 8-unit T-hangar, three 60'x60' corporate hangars, and accompanying taxiways on the west side of the Phase 1 hangars.	\$ 5,953,000	6	Columbus	100	25.55	Med	50	High	100	10	53.67	0	
B150514	Division Needs	Bicycle & Pedestrian	Construct sidewalk in Burgaw along E Freemont St from S Cowan St to Pender Memorial Hospital.	\$ 306,000	3	Pender	100	24.65	Med	50	High	100	10	53.40	0	
H170433	Regional Impact	Highway	Construct a 1-lane roundabout at NC 906 (Midway Rd) and SR 1501 (Gilbert Rd).	\$ 4,600,000	3	Brunswick	100	24.61	Med	50	High	100	10	53.38	0	
H090133-C	Statewide Mobility	Highway	Widen NC 87 to 4 lanes from R-2561CA at SR 1811 (Narrow Gap Road) to US 74 / 76.	\$ 137,900,000	6	Columbus	100	29.43	Med	50	Med	75	70	53.33	0	TIP: R-2561C Regional Points: 100
H090236-A	Regional Impact	Highway	Widen NC 906 (Midway Rd) to 4 lanes from NC 211 to Gilbert Rd (SR 1501).	\$ 63,600,000	3	Brunswick	100	17.56	Med	50	High	100	20	52.27	0	TIP: R-3434
H090133-B	Statewide Mobility	Highway	Widen NC 87 to 4 lanes from SR 1730 (Elwell Ferry Road) in Bladen County to R-2561CA at SR 1808 (Woodyard Road) in Columbus County.	\$ 126,500,000	6	Bladen, Columbus	6	23.15	Med	50	Med	75	50	49.45	0	TIP: R-2561B; 94% MCRPO
F230761	Regional Impact	Ferry	Additional Ramp and Gantry system at Fort Fisher to expand capacity.	\$ 25,900,875	3	Brunswick, New Hanover	50	31.67	Med	50	Med	75	20	49.00	0	50% WMPO
B230666	Division Needs	Bicycle & Pedestrian	Construct on-road bicycle lanes along Spivey Rd in Whiteville from US 74/76 BUS to Warrior Trail.	\$ 716,800	6	Columbus	100	29.16	Med	50	Med	75	20	48.25	0	
H230501	Statewide Mobility	Highway	Construct turn lanes at multiple intersections along NC 87 in Boiling Spring Lakes between S Shore Dr and Fifty Lakes Dr.	\$ 2,000,000	3	Brunswick	100	32.10	Med	50	Med	75	10	48.13	0	Regional Points: 81 (Remaining Available)
H183735	Regional Impact	Highway	Widen NC 211 to 4-lanes from US 17 to NC 906.	\$ 495,800,000	3	Brunswick	95	27.13	Med	50	Med	75	20	47.64	0	5% GSATS
F230647	Division Needs	Ferry	This project will replace the River Class vessel (M/V Southport) for a new River Class ferry.	\$ 25,768,160	3	Brunswick, New Hanover	50	23.59	Med	50	Med	75	20	46.58	0	50% WMPO
R231218	Statewide Mobility	Rail	Replacement of legacy signal crossing controllers (PMD-1S, 2S, & 3S) on the Wilmington Sub from Laurinburg (SE-266.05) to Castle-Hayne (SE-371.73) by upgrading to the most current PMD units at 42 at-grade crossings.	\$ 1,700,000	3, 6, 8	Bladen, Robeson, Scotland, Brunswick, New	10	26.39	Med	50	Med	75	10	46.42	0	90% in 3 Others
H150503	Regional Impact	Highway	Widen NC 53 to multi-lanes from US 117 BYP to Stag Park Rd.	\$ 20,800,000	3	Pender	100	18.89	Med	50	Med	75	30	46.17	0	TIP: R-5850
F230645	Division Needs	Ferry	This project will replace the River Class vessel (M/V Fort Fisher) for a new River Class ferry.	\$ 25,768,160	3	Brunswick, New Hanover	50	22.05	Med	50	Med	75	20	46.12	0	50% WMPO
H141033	Regional Impact	Highway	Realign NC 210 at SR 1120 (Malpass Corner Rd)/SR 1121 (Bell Williams Rd) to make NC 210 the through movement potentially using a roundabout.	\$ 3,300,000	3	Pender	100	24.41	Med	50	Med	75	10	45.82	0	
B230542	Division Needs	Bicycle & Pedestrian	Widen existing bike lanes in Oak Island along E Beach Dr from NC 906 (S Middleton Ave) to SE 58th St.	\$ 2,167,200	3	Brunswick	100	23.40	Med	50	Med	75	10	45.52	0	
T230658	Division Needs	Transit	Purchase an expansion demand response vehicle.	\$ 105,000	3	Pender	100	19.04	Med	50	Med	75	20	45.21	0	

R191574	Division Needs	Rail	Upgrade existing rail crossing of SR 1846 (Sand Hole Road) and the CSX SE Line (Crossing ID # 631 484H) in Riegelwood, NC with new asphalt surface and seal.	\$ 70,108	6	Columbus	100	25.16	Med	50	Med	75	0	45.05	0	
H184042	Regional Impact	Highway	Construct a roundabout on NC 11 at SR 1309 (Willard Railroad St) and SR 1310 (Veach St) in Willard.	\$ 4,700,000	3	Pender	100	21.40	Med	50	Med	75	10	44.92	0	
R191575	Division Needs	Rail	Upgrade this double rail crossing at SR 1818 (Neils Eddy Road) and the CSX SE Line to make the crossing level by raising the siding trackage. (Crossing ID # 631 488K) in Acme, NC.	\$ 211,968	6	Columbus	100	24.66	Med	50	Med	75	0	44.90	0	
B230711	Division Needs	Bicycle & Pedestrian	Construct separated bike lanes in Whiteville along SR 1916 (N Lee St) from US 74/76 BUS (Washington St) to Calhoun St.	\$ 1,897,600	6	Columbus	100	21.15	Med	50	Med	75	10	44.85	0	
B230709	Division Needs	Bicycle & Pedestrian	Construct sidewalk in Brunswick along SR 1170 (Poplar St) from NC 130 (Vinson Blvd) to Maple St.	\$ 188,200	6	Columbus	100	19.93	Med	50	Med	75	10	44.48	0	
B191643	Division Needs	Bicycle & Pedestrian	Construct multiuse path on the north side of Fifty Lakes Drive from NC 87 to Eden Drive in Boiling Spring Lakes.	\$ 3,144,800	3	Brunswick	100	19.84	Med	50	Med	75	10	44.45	0	
H230500	Regional Impact	Highway	Upgrade intersection in Oak Island at NC 906 (Middleton Ave) and SR 1190 (Oak Island Dr) to roundabout for congestion mitigation.	\$ 7,800,000	3	Brunswick	100	20.95	Med	50	Med	75	0	43.79	0	
B191659	Division Needs	Bicycle & Pedestrian	Construct a multi-use path on the west side of NC 50 from Davis Ave to Hispaniola Lane in Topsail Beach.	\$ 7,623,000	3	Pender	100	11.50	Med	50	Med	75	10	41.95	0	
F230648	Regional Impact	Ferry	Replace the aging Southport & Fort Fisher Visitor Center.	\$ 25,900,875	3	Brunswick, New Hanover	50	32.44	Low	25	Med	75	10	40.73	0	50% WMPO Regional Points: 100 (50 Donated)
B150517	Division Needs	Bicycle & Pedestrian	Construct sidewalks in Burgaw on NC 53 along the Osgood Canal Trail with improved crossings on US 117 BUS and US 117 BYP.	\$ 764,800	3	Pender	100	19.29	Low	25	Med	75	10	36.79	0	
H230687	Statewide Mobility	Highway	Provide access management along US 17 (Ocean Hwy) from NC 87 to Carol Lynn Dr NE with a flyover left turn from US 17 to NC 87.	\$ 275,600,000	3	Brunswick	100	22.35	Med	50	Low	50	0	36.71	0	
F192745	Regional Impact	Ferry	Replace the deteriorated current water tower with new 200,000 gallon ground storage tank at a new location in the Manns Harbor Shipyard.	\$ 10,000,000	1, 2, 3	Currituck, Dare, Hyde, Beaufort, Pamlico, Craven, Carteret, Brunswick, New Hanover	20	25.77	Low	25	Low	50	20	32.23	0	80% in 4 Others
F231106	Regional Impact	Ferry	Construction of a dorm facility at the Manns Harbor Shipyard.	\$ 3,000,000	1, 2, 3	Currituck, Dare, Hyde, Beaufort, Pamlico, Craven, Carteret, Brunswick, New Hanover	20	28.85	Low	25	Low	50	10	32.16	0	80% in 4 Others
H192858	Statewide Mobility	Highway	Future I-74 / Carolina Bays Parkway - Extend SC 9 in Horry County to NC 904 in Brunswick County.	\$ 313,800,000	3	Brunswick	37	19.41	Low	25	Low	50	30	31.32	0	TIP: R-5876; 63% GSATS
H090287-AE	Statewide Mobility	Highway	Future I-74 (Delco Bypass) - Construct Interstate on new location from west of SR 1844 (Oscar Blanks Road) to east of the Columbus / Brunswick County Line.	\$ 265,000,000	3, 6	Columbus, Brunswick	100	15.22	Low	25	Low	50	40	31.07	0	TIP: R-4462
F231109	Division Needs	Ferry	Repalce the aging crane barge Skyco that performs piling, bulkhead, and ramp and gantry work at each Ferry terminal in the system.	\$ 8,857,805	1, 2, 3	Currituck, Dare, Hyde, Beaufort, Pamlico, Craven, Carteret, Brunswick, New Hanover	20	20.39	Low	25	Low	50	20	30.62	0	80% in 4 Others
B230667	Division Needs	Bicycle & Pedestrian	Construct on-road bicycle lanes along Warrior Trail in Whiteville from Spivey Rd to US 701 BUS (Pinckney St)	\$ 609,800	6	Columbus	100	20.29	Low	25	Low	50	20	30.59	0	
R184030	Statewide Mobility	Rail	Construct a grade separation of SR 1426 (Mt. Misery Rd) over the CSX SE Line and closure of the existing at-grade crossing (Crossing # 631 494N)	\$ 13,600,000	3	Brunswick	100	23.56	Low	25	Low	50	10	30.57	0	
R191560	Statewide Mobility	Rail	Construct a grade separation of the SR 1846 (Sand Hole Road) and closure of an existing at-grade crossing (Crossing #631 484H) near Riegelwood.	\$ 15,100,000	6	Columbus	100	23.23	Low	25	Low	50	10	30.47	0	
B230529	Division Needs	Bicycle & Pedestrian	Construct sidewalk in Southport along E Leonard St from NC 211 (N Howe St) to N Fodale Ave.	\$ 536,200	3	Brunswick	100	18.75	Low	25	Low	50	10	29.13	0	

H185083	Division Needs	Highway	Construct a new 2-lane roadway in Whiteville extending SR 1439 (Legion Dr) from Washington St to Smyrna Rd.	\$ 20,200,000	6	Columbus	100	18.39	Low	25	Low	50	10	29.02	0	
H184422	Regional Impact	Highway	Improve the intersection(s) at Court House Dr NE and/or at Government Center Dr NE at the Brunswick County Government Complex potentially including roundabouts or turn lane improvements.	\$ 4,700,000	3	Brunswick	100	21.00	Low	25	Low	50	0	28.80	0	
H231097	Statewide Mobility	Highway	Future I-74 / Carolina Bays Parkway - Construct new roadway (4-lane freeway) with RCI's at multiple intersections and interchange at NC 904.	\$ 313,800,000	3	Brunswick	38	17.45	Low	25	Low	50	10	28.74	0	62% GSATS
R231208	Regional Impact	Rail	Upgrade rail infrastructure to support new intercity passenger service from Wilmington to Raleigh via Fayetteville and Pembroke. This includes necessary infrastructure, stations, and passenger equipment to begin service with three roundtrips per day. This project is contingent upon the awarding of an 80/20 federal grant and if the grant is not awarded, then the project is void.	\$ 188,050,000	3, 5, 6	Robeson, Bladen, Cumberland, Harnett, Wake, Brunswick, Columbus, New Hanover	7	17.34	Low	25	Low	50	10	28.70	0	93% in 6 Others
R140031	Regional Impact	Rail	Restoration of the Wallace to Castle Hayne Rail Corridor from just north of Wilmington to Wallace. This project is contingent upon the awarding of an 80/20 federal grant and if the grant is not awarded, then the project is void.	\$ 48,526,500	3	Pender, Duplin, New Hanover	75	16.38	Low	25	Low	50	10	28.41	0	20% WMPO; 5% ECRPO
H230404	Regional Impact	Highway	Widen NC 50 (Ocean Rd) from US 17 to NC 210.	\$ 47,300,000	3	Pender, Onslow	43	15.56	Low	25	Low	50	10	28.17	0	57% JUMPO
R184031	Statewide Mobility	Rail	Construct a grade separation of SR 1740 (Old Lake Rd) over the CSX SE Line and closure of existing at-grade crossing (Crossing #631 483B)	\$ 12,600,000	6	Columbus	100	18.73	Low	25	Low	50	0	28.12	0	
B170758	Division Needs	Bicycle & Pedestrian	Construct sidewalk in Chadbourn on E 3rd St from NC 410 to N Pine St (Chadbourn Elem. School).	\$ 527,800	6	Columbus	100	15.17	Low	25	Low	50	10	28.05	0	
B230664	Division Needs	Bicycle & Pedestrian	Construct sidewalk in Tabor City along SR 1300 (Stake Rd) from the end of existing sidewalk near Carter St at Tabor Elementary to Barry St, as requested in the Tabor City CTP.	\$ 714,400	6	Columbus	100	13.84	Low	25	Low	50	10	27.65	0	
T230621	Division Needs	Transit	Purchase new vehicle and two bus shelters for park and ride shuttle service in Oak Island.	\$ 190,100	3	Brunswick	100	10.98	Low	25	Low	50	10	26.79	0	
B191658	Division Needs	Bicycle & Pedestrian	Construct a multi-use path on the east side of NC 50 from Crews Ave to Trout Ave in Topsail Beach.	\$ 3,452,600	3	Pender	100	10.94	Low	25	Low	50	10	26.78	0	
H184409	Regional Impact	Highway	Upgrade NC 50 (S Anderson Blvd) to a 2-lane curb and gutter with sidewalks and on-street parking from Topsail Beach Town Center near Maritime Way to Crews Ave.	\$ 13,500,000	3	Pender	100	10.28	Low	25	Low	50	10	26.58	0	
B191657	Division Needs	Bicycle & Pedestrian	Construct sidewalks on both sides of NC 50 through the central business district of Topsail Beach.	\$ 181,200	3	Pender	100	9.39	Low	25	Low	50	10	26.32	0	
R150529	Statewide Mobility	Rail	Restoration of the Wallace to Castle Hayne Rail Corridor from Wallace to Burgaw (phase 1) per Pender Co CTP project PEND0001-R.	\$ 61,211,500	3	Pender, Duplin	93	8.91	Low	25	Low	50	10	26.17	0	7% ECRPO
B231161	Division Needs	Bicycle & Pedestrian	Connect and construct an MUP along NC 50 (S Shore Drive/ S Topsail Drive/ N Topsail Drive) from just south of Hispaniola Drive (Surf City and Topsail Beach municipal boundary)	\$ 5,775,000	3	Pender	100	7.72	Low	25	Low	50	10	25.82	0	
H193097	Statewide Mobility	Highway	Upgrade US 17 to a controlled access facility with service roads from SR 1563 (Sloop Point Loop Rd) to NC 210.	\$ 195,700,000	3	Pender	16	25.06	Med	50	None	0	10	23.52	0	84% WMPO Regional Points: 100 (84 Donated)
A230639	Division Needs	Aviation	ACZ (Henderson Field) - Replace existing fuel farm and relocate it to correspond with the airport's new development area.	\$ 1,847,200	3	Pender	100	16.10	None	0	Low	50	10	20.83	0	
H090237-A	Statewide Mobility	Highway	Future I-74 (Carolina Bays Parkway Ext.) - Construct multi-lane freeway on new location from the SC state line to US 17/NC 130 interchange.	\$ 659,900,000	3	Brunswick	50	19.42	None	0	None	0	70	12.83	0	TIP: R-5876; 50% GSATS
A230636	Division Needs	Aviation	ACZ (Henderson Field) - Construct perimeter fencing to mitigate wildlife access to airport property.	\$ 2,691,000	3	Pender	100	26.40	None	0	None	0	10	8.92	0	
A191605	Division Needs	Aviation	ACZ (Henderson Field) - Site preparation for and construction of an 8-unit hangar.	\$ 3,520,000	3	Pender	100	25.34	None	0	None	0	10	8.60	0	
R230522	Regional Impact	Rail	Upgrade rail infrastructure to support new intercity passenger service from Wilmington to Raleigh via Goldsboro. Project includes necessary infrastructure, stations, and passenger equipment to begin service with three roundtrips per day. This project is contingent upon the awarding of an 80/20 federal grant and if the grant is not awarded, then the project is void.	\$ 155,787,800	3, 4, 5	Duplin, Johnston, Pender, Wayne, Wake, New Hanover	16	24.68	None	0	None	0	10	8.40	0	84% in 5 Others Regional Points: 16

H230876	Statewide Mobility	Highway	Elevate existing 4 lanes of I-40 from MM 387 to MM 389 15 feet to account for flooding.	\$ 112,500,000	3	Pender, Duplin	58	25.17	None	0	None	0	0	7.55	0	42% ECRPO
H090236-B	Regional Impact	Highway	Widen NC 906 (Midway Rd) to 3 lanes on 4-lane right-of-way and realign the offset intersection of Midway Rd and Galloway Rd with US 17 Business (Old Ocean Hwy).	\$ 26,700,000	3	Brunswick	100	15.69	None	0	None	0	20	6.71	0	TIP: R-3434
H090287-E	Statewide Mobility	Highway	Upgrade at-grade intersection in Bolton to interchange - US 74/76 and NC 214 (Sam Potts Hwy).	\$ 20,500,000	6	Columbus	100	7.06	None	0	None	0	40	6.12	0	TIP: R-4462
R230524	Regional Impact	Rail	Upgrade and construct rail infrastructure to support new intercity passenger service from Wilmington to Goldsboro. Project includes necessary infrastructure, stations, and passenger equipment to begin service with three roundtrips per day. This project would also include a maintenance facility at one endpoint. This project is contingent upon the awarding of an 80/20 federal grant and if the grant is not awarded, then the project is void.	\$ 132,443,200	3, 4	Duplin, Pender, Wayne, New Hanover	24	15.81	None	0	None	0	10	5.74	0	76% in 3 Others
H192933	Regional Impact	Highway	Construct a roundabout at the intersection of NC 410 (N Brown St) and US 74 Busines (E Strawberry Blvd) and a grade-separation at the intersection of NC 410 (N Brown St) and US 76 (Andrew Jackson Hwy).	\$ 9,500,000	6	Columbus	100	11.59	None	0	None	0	20	5.48	0	
T230661	Division Needs	Transit	Purchase two bus shelters to be placed at the park and ride lot.	\$ 55,100	3	Brunswick	100	14.86	None	0	None	0	10	5.46	0	
B191636	Division Needs	Bicycle & Pedestrian	Construct multi-use path on NC 87 in Boiling Spring Lakes from the Community near Fairway Dr to Cougar Rd.	\$ 2,443,800	3	Brunswick	100	13.94	None	0	None	0	10	5.18	0	
H184020	Division Needs	Highway	NC 242 (Cerro Gordo Bypass) - Construct a 2-lane roadway on new location including a grade-separated crossing of the RJ Corman rail.	\$ 39,200,000	6	Columbus	100	12.98	None	0	None	0	10	4.89	0	
R150532	Statewide Mobility	Rail	Restoration of the Wallace to Castle Hayne Rail Corridor from Burgaw to Castle Hayne (phase 2) per Pender Co CTP project PEND0001-R.	\$ 185,711,500	3	Pender, New Hanover	60	12.15	None	0	None	0	10	4.65	0	40% WMPO
R170434	Statewide Mobility	Rail	Restore the former Atlantic Coast Rail line from Malmo to the International Logistics Park near the Columbus/Brunswick County Line.	\$ 24,795,000	3	Brunswick	78	11.35	None	0	None	0	10	4.41	0	22% WMPO
R231210	Regional Impact	Rail	Upgrade rail infrastructure to support new intercity passenger service from Charlotte to Wilmington via Hamlet on the CSX SF and SE Lines. Project includes necessary infrastructure, stations, and passenger equipment to begin service with three roundtrips per day.	\$ 1,001,220,000	3, 6, 8, 10	Bladen, Robeson, Anson, Union, Scotland, Richmond, Mecklenburg, Brunswick, Columbus, New Hanover	7	11.25	None	0	None	0	10	4.38	0	93% in 5 Others
H150504	Division Needs	Highway	Antenna Farm Rd - Construct a roadway partially on new location partially on land owned by the State and partially on existing municipal right-of-way (W Boiling Spring Rd) from NC 87 (George II Hwy) to NC 906 (Midway Rd) per Brunswick Co CTP.	\$ 41,000,000	3	Brunswick	100	10.74	None	0	None	0	10	4.22	0	
R170043	Statewide Mobility	Rail	Restoration of the former Atlantic Coast Rail line from Malmo to the RJ Corman Carolina line in Whiteville. Conceptual study completed by NCDOT FS-1706A.	\$ 178,785,000	3, 6	Columbus, Brunswick	96	10.66	None	0	None	0	10	4.20	0	4% WMPO
H230997	Division Needs	Highway	Widen Stake Rd (SR 1300) from US 701 BYP (E 5th St) to E 8th St to 3-lane curb and gutter with sidewalk on west side. Reconfigure US 701 Business (E. 5th Street) /NC 904/SR 1300 (Stake Road) intersection to accommodate trucks.	\$ 5,300,000	6	Columbus	100	9.21	None	0	None	0	10	3.76	0	
B170440	Division Needs	Bicycle & Pedestrian	Construct a multi-use path from the Lake Waccamaw State Park parking lot to the Lake Waccamaw spillway bridge.	\$ 4,588,800	6	Columbus	100	4.89	None	0	None	0	20	3.47	0	
R230584	Regional Impact	Rail	Modernization of CSX SE Line between MP 253.74 and 371 (Castle Hayne to Hamlet) to increase the overall train capacity of the corridor.	\$ 214,000,000	3, 6, 8	Bladen, Robeson, Scotland, Brunswick, New Hanover, Columbus, Richmond	11	7.30	None	0	None	0	0	2.19	0	89% in 3 Others

Cape Fear RPO

P7.0 Local Input Prioritization Methodology

NCDOT approval 4-15-24

CFRPO RTAC approval 4-12-24

INTRODUCTION

The Cape Fear RPO (CFRPO) is required by state law to develop a local input methodology for prioritizing all transportation projects (aviation, bicycle and pedestrian, ferry, highway, public transportation, and rail) within the RPO boundary that compete for state and federal funding, and to submit the methodology to the NC Dept. of Transportation for approval. This Local Input Prioritization Methodology applies within the Cape Fear RPO planning boundary, which includes the counties of Brunswick (partial), Columbus, and Pender (partial).

The RPO has developed this prioritization methodology in an effort to satisfy the quantitative, data-driven requirements of the STI (Strategic Transportation Investments) law while protecting the discretion of local officials by incorporating subjective, qualitative local input where possible. STI establishes a funding formula which allocates available revenues based on data-driven scoring and local input. It is used to develop NCDOT's State Transportation Improvement Program (STIP), which identifies the transportation projects that will receive funding during a specified 10-year period.

Transportation projects competing for funding through STI are divided into three tiers based on project characteristics as follows:

Statewide Mobility: Projects in this tier compete statewide. Eligible projects include:

- Interstate highways and designated future interstates, including I-40 and Future I-74;
- National Highway System highways and STRAHNET highways, including US 17, US 74 and US 76; and
- Freight capacity and safety improvements to Class I freight rail corridors, including the CSX rail line in Brunswick and Columbus counties and the abandoned Wallace-Castle Hayne line in Pender County.

Regional Impact: In the Cape Fear RPO region, projects in Brunswick and Pender counties compete in Region B with eligible projects throughout the 14 counties in NCDOT Divisions 2 and 3, including the cities of Wilmington, Jacksonville, Greenville, New Bern, Kinston, and Morehead City. Projects in Columbus County compete in Region C with eligible projects throughout the 12 counties in NCDOT Divisions 5 and 6, including the cities of Raleigh, Durham, Fayetteville, Cary, and Lumberton. Eligible projects include:

- Statewide Mobility projects not funded at the Statewide Mobility tier;

- US and NC highways not eligible at the Statewide Mobility tier, including US 117, US 421, US 701, US 17 Business, US 117 Business, US 701 Business, NC 11, NC 50, NC 53, NC 87, NC 130, NC 210, NC 211, NC 214, NC 410, NC 904, and NC 906; and
- The State-maintained ferry system, excluding passenger vessel replacement, including improvements and expansions to the Southport-Ft. Fisher ferry.

Division Needs: In the Cape Fear Region, projects in Brunswick and Pender counties compete with eligible projects throughout NCDOT Division 3, including the cities of Wilmington and Jacksonville. Projects in Columbus County compete with eligible projects throughout NCDOT Division 6, including the cities of Fayetteville and Lumberton. Eligible projects include:

- Statewide Mobility projects not funded at the Statewide Mobility or Regional Impact tiers and Regional Impact projects not funded at the Regional Impact tier;
- State-maintained secondary routes and federally funded municipal road projects, including E Boiling Spring Rd, Gilbert Rd, Old Lake Rd, Hallsboro Rd, Shaw Hwy, Penderlea Hwy, and Malpass Corner Rd;
- General aviation airports, including Cape Fear Jetport (SUT) near Southport, Columbus County Airport (CPC) near Whiteville, and Henderson Field (ACZ) in northern Pender County;
- Community public transportation systems, including Brunswick Transit, Columbus Transportation, and PAS-TRAN;
- Standalone bicycle and pedestrian transportation projects, including sidewalks, bike lanes, and multi-use paths; and
- Replacement of ferry vessels, including those on the Southport-Ft. Fisher route.

This methodology describes the process by which the Cape Fear RPO evaluates transportation projects and assigns local input points to qualifying transportation projects according to local priorities. The Cape Fear RPO has 1300 local input points available for assignment to eligible projects at both the Regional Impact and Division Needs tiers. Projects may receive no more than 100 total points from local transportation planning organizations (MPOs and RPOs); therefore, the Cape Fear RPO will assign points to a minimum of 13 transportation projects at both tiers.

DESCRIPTION OF CRITERIA

The following scoring criteria will be used to generate a total project score for each CFRPO transportation project, regardless of mode. Each project will receive a total project score at the Regional Impact tier and/or Division Needs tier according to its eligibility.

1. **PRIORITIZATION 7.0 QUANTITATIVE SCORE (QUANTITATIVE):** The Cape Fear Area RPO believes that the Prioritization 7.0 Quantitative Score (“P7.0 Score”) is the best criterion to maximize the funding potential of the transportation projects in the RPO area.

Projects that do not score well by the P7.0 Score will have difficulty competing for funding. The criterion is defined as the project's P7.0 Score for the corresponding tier.

2. **DIVISION PRIORITY (QUALITATIVE):** Projects will not be competitive at the Regional Impact or Division Needs tier unless they have the support of the Division Engineer and rank well by the Division Engineer's scoring criteria. The Cape Fear RPO will request that Division Engineers or their designees assign each project a HIGH, MEDIUM, LOW, or NONE priority classification for each tier at which the project competes. Division Engineers should assign priority classifications such that projects are distributed with an approximately equal number of projects in each classification. Projects will be given 100, 50, 25, or 0 points according to their classification. Where projects are located in both Divisions 3 and 6, Division Priority points will be allocated based on the share of the project in each division.
3. **COUNTY PRIORITY (QUALITATIVE):** Projects should have local support. County RTCC representatives are expected to collaborate with other county staff, county elected officials, staff, and elected officials of municipalities within their boundaries, and other stakeholders representing county transportation modes or systems, as deemed appropriate by each county's RTCC representative, to develop county priorities. Each county RTCC representative will assign every project within the county a HIGH, MEDIUM, LOW, or NONE priority classification for each tier at which the project competes. County RTCC representatives should assign priority classifications such that projects are distributed with an approximately equal number of projects in each classification. Projects will be given 100, 75, 50, and 0 points according to their classification. If a project is prioritized by more than one CFRPO county, it will be assigned the average of the points received.
4. **PROJECT DEVELOPMENT (QUALITATIVE):** Projects that have had significant planning or development activities completed are eligible for additional points to distinguish them from projects that are simply conceptual. Points will be given cumulatively to projects for each of the following criteria as indicated for a maximum of 100 points: a feasibility study has been completed or a corridor plan or other project-specific plan has been adopted [10 pts.]; preliminary design or engineering has begun [10 pts.]; project was programmed in a prior STIP or otherwise was in the development/merger process [10 pts.]; right-of-way attainment has begun, was previously completed, or is otherwise not expected to be required [10 pts.]; project sibling is funded in the current STIP or has been completed [20 pts.]; project is programmed in the current STIP [40 pts.].

TOTAL PROJECT SCORE AND RANKING APPROACH

Project rankings will be developed at each tier using the total project scores of eligible projects. Project scores will be calculated as follows:

Regional Impact tier score

$$= (0.50 \times P7.0 \text{ Score for tier}) + (0.20 \times \text{Division Priority points for tier}) \\ + (0.20 \times \text{County Priority points for tier}) + (0.10 \times \text{Project Development points})$$

Division Needs tier score

$$= (0.30 \times P7.0 \text{ Score for tier}) + (0.30 \times \text{Division Priority points for tier}) \\ + (0.30 \times \text{County Priority points for tier}) + (0.10 \times \text{Project Development points})$$

POINT ASSIGNMENT PROCESS

Preliminary Point Assignments: Preliminary points will be assigned at both the Regional Impact and Division Needs tiers based on the project ranking. Preliminary points may be assigned to any project eligible to receive points at the respective tier if it has not been fully funded at a higher tier. Preliminary point assignments will take into consideration the share of the project within the RPO and point sharing opportunities.

Any project that crosses the RPO boundary will be eligible for local input points in excess of the percentage of the project within the RPO boundary, up to 100 points, if the adjacent MPO/RPO provides less than their full share of points. Any project entirely beyond the RPO boundary will be eligible for up to 100 local input points to be shared with the adjacent MPO/RPO if the project has benefits to a primary route between the RPO area and major destinations outside of the RPO area. The Cape Fear RPO will endeavor to accept points shared by adjacent MPO/RPOs for projects crossing the RPO boundary that would otherwise not receive Cape Fear RPO points according to the point assignment process unless doing so is determined to jeopardize the funding potential of a higher priority Cape Fear RPO project. If points sharing is approved, both the Cape Fear RPO and the adjacent MPO/RPO must agree to the number of points donated and provide this arrangement in writing to NCDOT's Office of Prioritization.

Preliminary points will be assigned until all 1300 available points are assigned at each tier as follows:

1. The top two scoring highway projects in each RPO county will be eligible for 100 points each (600 points max).
2. The top three scoring non-highway projects will be eligible for 100 points each, regardless of non-highway mode or location (300 points max).
3. Remaining points cascade to the next highest scoring projects, regardless of mode or location, up to 100 points each.

Preliminary point assignments will be posted to the Cape Fear RPO website. If time permits, the RTCC will recommend and the RTAC will approve preliminary point assignments. Otherwise, the RPO staff will approve preliminary point assignments.

Local Input Point Flexing Policy: The Cape Fear RPO has the option to apply the Local Input Point Flexing Policy. This means that up to 500 Local Input Points can be transferred from one category (Regional Impact or Division Needs) to the other. If the organization chooses to flex Local Input Points, Cape Fear RPO will provide written documentation to the SPOT Office prior to assigning Regional Impact Local Input Points.

Final Point Assignments: Preliminary point assignments may be modified by the RTAC to provide local oversight to the data-driven process, to compensate for situations where the methodology does not accurately reflect the RTAC's priorities, and to ensure appropriate projects at the relevant tier. Justifications for modifying preliminary point assignments include project cost, point sharing arrangements, estimated points required for funding, geographic equity, modal distribution, new information, methodology failures, potential reconsideration of the limits of a programmed project, and public comment. The justifications for any final point assignments that deviate from published preliminary point assignments will, at minimum, be noted in the final point assignment worksheet and documented in the meeting minutes. In the event that projects receiving final point assignments become unexpectedly uncompetitive due to any last-minute deviations in actual or expected point assignments by NCDOT Division Engineers or other transportation planning organizations (MPOs or RPOs), the RTAC delegates to its chair the power to modify final point assignments to maximize project competitiveness. Any such modification and accompanying justification will be noted in an amended final point assignment worksheet, which will be posted to the RPO website.

SCHEDULE

The following schedule is subject to change for a variety of reasons, many of which are beyond the control of the RPO. Any change to the schedule will be updated on the RPO website and in this document, which will be also available on the RPO website; however, modification to the timeline will not require public notice or comment, nor adoption by the RTAC, nor approval by NCDOT.

1. Draft prioritization methodology will be developed by RPO staff. [Winter/Spring 2024]
2. Draft prioritization methodology will be submitted to the RTCC for recommendation and to the RTAC for preliminary approval. [February 2024]
3. Draft prioritization methodology will be revised as necessary to conform with NCDOT guidelines, posted to RPO website, and submitted to NCDOT for conditional approval. [March 2024]

4. Conditionally approved methodology will be recommended for final approval by the RTCC and approved by the RTAC. Approved methodology will be posted to the RPO website once approved by NCDOT and the RTAC. [April 2024]
5. RPO staff will determine **PROJECT DEVELOPMENT** points for all projects eligible to compete at the Regional Impact tier. [May – August 2024]
6. The RTCC representative from each RPO county will assign a **COUNTY PRIORITY** to each project within the county competing at the Regional Impact tier according to the Description of Criteria. [June/July 2024]
7. NCDOT Division Engineers will assign a **DIVISION PRIORITY** to each project competing at the Regional Impact tier according to the Description of Criteria. [June/July 2024]
8. RPO staff will discuss point sharing with staff of other MPO/RPOs. [June/July 2024]
9. Regional Impact project scores, rankings, and preliminary point assignments will be generated according to the Point Assignment Process. [July 2024]
10. RTCC will recommend and RTAC will make final Regional Impact point assignments at their August meetings. RTCC and RTAC meetings are public meetings where public comment on point assignments will specifically be sought. [August 2024]
11. Final Regional Impact tier point assignments will be entered into SPOT On!ine and posted to the CFRPO website. [August 2024]
12. RPO staff will determine **PROJECT DEVELOPMENT** points for all Division Needs tier projects. [September – November 2024]
13. The RTCC representative from each RPO county will assign a **COUNTY PRIORITY** to each project within the county competing at the Division Needs tier according to the Description of Criteria. [October/November 2024]
14. NCDOT Division Engineers will assign a **DIVISION PRIORITY** to each project competing at the Division Needs tier according to the Description of Criteria. [October/November 2024]
15. RPO staff will discuss point sharing with staff of other MPO/RPOs. [October/November 2024]
16. Division Needs project scores, rankings, and preliminary point assignments will be generated according to the Point Assignment Process. [November 2024]
17. RTCC will recommend and RTAC will make final Division Needs point assignments at their December meetings. RTCC and RTAC meetings are public meetings where public comment on point assignments will specifically be sought. [November 2024]
18. Final Division Needs point assignments will be entered into SPOT On!ine and posted to the CFRPO website. [November 2024]

PUBLIC OUTREACH

This process is intended to be open and transparent. As such, all meetings of the RTCC and RTAC are open to the public and public comment is a recurring item on all meeting agendas. In addition, RTCC and RTAC meeting dates and, as available, agendas and minutes are available on the RPO website at <http://www.capefearrpo.org>. Relevant documents, including this methodology and preliminary and final point assignments, will also be posted for public review at the RPO's website. Public comment is specifically sought on preliminary point assignments during the 30 days prior to final point assignment by the RTAC and during the public comment period for the RTAC meeting where final points are assigned, currently scheduled for August 16, 2024 for the Regional Impact tier and November 15, 2024 for the Division Needs tier. Meeting date changes and accompanying changes in public comment periods will be posted to the RPO website. Additionally, instructions for submitting public comments outside of official meetings will be provided on the RPO website. At minimum, comments may be submitted in person, by telephone, or via email. Comments will be collected by RPO staff and distributed to the RTCC and RTAC as part of their normal meeting materials.

MATERIAL SHARING

The following information, at minimum, will be made available on the Cape Fear RPO website:

- A link to the NCDOT STI Prioritization Resources website;
- The adopted Cape Fear RPO P7.0 Local Input Prioritization Methodology;
- Highlights of schedule milestones, including public comment periods and public meeting schedules; and
- Preliminary and final local input point assignment sheets, including justifications of methodology deviations.

APPROVED BY THE CAPE FEAR RPO TRANSPORTATION ADVISORY COMMITTEE ON **04/12/2024**.



Frank Williams, Chair



Sam Boswell, Secretary

The Cape Fear Rural Transportation Planning Organization serves as the intergovernmental organization for local elected officials, the North Carolina Department of Transportation, and residents of Brunswick, Columbus, and Pender Counties to work cooperatively to address transportation issues.

***DRAFT* Cape Fear RPO 2025 Meeting Schedule**

RTCC	RTAC	Deadlines/Important Dates
Wed 2/5/25	Fri 2/14/2025	Draft 2026-2035 STIP to be released in January 2025. Draft FY 25-26 PWP due 2/28/2025 . New Appointments/Elections.
Wed 4/2/25	Fri 4/11/2025	RTAC Ethics Paperwork due 4/15/2025 . Final FY 25-26 PWP due 5/31/2025 .
Wed 6/4/2025	Fri 6/13/2025	Final FY 24-25 PWP amendment due 6/30/2025 .
Wed 8/6/2025	Fri 8/15/2025	
Wed 10/1/2025	Fri 10/10/2025	
Wed 11/5/2025	Fri 11/14/2025	Draft FY 26-27 PWP due 2/28/2026 . Expiring Positions/New Appointments.

RTCC (staff) will meet at **10:30 AM** via Zoom.

RTAC (elected officials) typically meet at **9:00 AM** at the Cape Fear COG office (Zoom available).

REVISIONS TO THE 2024-2033 STIP
HIGHWAY PROGRAM

CAPE FEAR RURAL PLANNING ORGANIZATION

STIP MODIFICATIONS

BN-0006 COLUMBUS PROJ.CATEGORY EXEMPT	- CAPE FEAR RURAL PLANNING ORGANIZATION	US 701 BUSINESS (E 5TH STREET), FROM JESSIE STREET TO LYNWOOD NORRIS ROAD IN TABOR CITY. CONSTRUCT SIDEWALK. <u>TO ALLOW ADDITIONAL TIME FOR PLANNING AND DESIGN, DELAY CONSTRUCTION FROM FY 24 TO 25.</u>	CONSTRUCTION	FY 2025 - \$2,000 (CRPLT5) FY 2025 - \$1,000 (HF(M)) FY 2026 - \$198,000 (CRPLT5) FY 2026 - \$49,000 (HF(M)) \$250,000
EB-5982 BRUNSWICK PROJ.CATEGORY DIVISION	- CAPE FEAR RURAL PLANNING ORGANIZATION	NC 211 (NORTH HOWE STREET), EAST OWEN STREET TO DOSHER HOSPITAL IN SOUTHPORT. CONSTRUCT SIDEWALK. <u>TO ALLOW ADDITIONAL TIME FOR PLANNING AND DESIGN, DELAY RIGHT-OF-WAY FROM FY 24 TO FY 25.</u>	RIGHT-OF-WAY CONSTRUCTION	FY 2025 - \$40,000 (TA5T50) FY 2025 - \$10,000 (L(M)) FY 2025 - \$140,000 (TA5T50) FY 2025 - \$35,000 (L(M)) \$225,000
HS-2003AC PENDER PROJ.CATEGORY REGIONAL	- CAPE FEAR RURAL PLANNING ORGANIZATION	US 117, AT SR 1411 (ASHTON ROAD / OLD RIVER ROAD). INSTALL TRAFFIC SIGNAL. <u>TO ALLOW ADDITIONAL TIME FOR MATERIAL ACQUISITION, DELAY CONSTRUCTION FROM FY 24 TO FY 25.</u>	CONSTRUCTION	FY 2025 - \$325,000 (HSIP) \$325,000
* HS-2406Q COLUMBUS PROJ.CATEGORY REGIONAL	- CAPE FEAR RURAL PLANNING ORGANIZATION	NC 410 (BROWN STREET), FIRST AVENUE INTERSECTION IN CHADBOURN. UPGRADE TRAFFIC SIGNAL WITH PEDESTRIAN HEADS. <u>ADD PROJECT BREAK AT THE REQUEST OF THE TRANSPORTATION MOBILITY AND SAFETY DIVISION.</u>	CONSTRUCTION	FY 2025 - \$85,000 (HSIP) \$85,000

* INDICATES FEDERAL AMENDMENT

CFRPO SEPTEMBER PROJECTS IN DEVELOPMENT

Project Manager	Contract Type	TIP	PO	Description	County	*SAP LET Date
Tim Sherrill	Raleigh	15BPR.138	CFRPO	BRIDGE PRESERVATION. BRIDGE 700016 OVER ICWW ON NC 50/NC 210. Lighting	Pender	2024.08.20
Derek Pielech	DDRL	BR-0139	CFRPO	REPLACE CULVERT 3 OVER SAND HILL CREEK AND TWO OTHER CULVERTS ON NC 133 (RIVER ROAD).	Brunswick	2024.09.17
Derek Pielech	DPOC	BR-0174	CFRPO	REPLACE BRIDGE 700037 ON NC 53 OVER ANGOLA CREEK.	Pender	2025.10.21
Derek Pielech	LET	BP3-R011	CFRPO	REPLACE BRIDGE 68 ON SR 1306 (OLD MILL ROAD) OVER SILL'S CREEK.	Pender	2026.07.16
Zach Howard	DPOC	R-5899	CFRPO	NC 210 PENDER COUNTY AT SR 1560 (WATTS LANDING ROAD). CONSTRUCT ROUNDABOUT.	Pender	2027.03.18
Brandon Powers	DPOC	R-5701	CFRPO	NC 53 AT US 117 BUSINESS (WALKER/WILMINGTON STREET), IMPROVE INTERSECTION	Pender	2027.06.03
Derek Pielech	DPOC	B-5627	CFRPO	BRIDGE 11 ON NC 87 OVER ORTON POND CREEK.	Brunswick	2027.07.15
Derek Pielech	DPOC	17BP.3.R.62	CFRPO	REPLACE BRIDGE 23 ON NC 906/MIDWAY ROAD OVER BRUNSWICK RIVER SWAMP.	Brunswick	2027.07.15
Zach Howard	DDRL	R-5900	CFRPO	NC 50/NC 210 PENDER COUNTY AT SR 1534 (BELT ROAD). INTERSECTION IMPROVEMENTS.	Pender	2027.10.19
John Abel	DDRL	F-5705	CFRPO/WMPO	SOUTHPORT - FORT FISHER FERRY. CONSTRUCT RIVER CLASS FERRY.BRUNSWICK & NEW HANOVER COUNTIES.	Brunswick/New Hanover	2029.01.16
Derek Pielech	LET	BP3-R015	CFRPO	REPLACE BRIDGE 22 ON SR 1112 (SUNSET HARBOR ROAD SE) OVER MERCERS MILL POND	Brunswick	2030.06.20
Trace Howell	DDRL	U-5732	WMPO/ CFRPO	HAMPSTEAD MEDIAN: US 17 FROM SR 1582 (WASHINGTON ACRES ROAD) TO VISTA LANE. CONVERT TO SUPERSTREET.	Pender	2031.01.21
Brandon Powers	DDRL	U-5932	CFRPO/GSATS	US 17 AT NC 211 CONVERT TO INTERCHANGE.	Brunswick	2032.06.15
Zach Howard	DPOC	R-5877	CFRPO	US 17 PENDER COUNTY AT NC 210 (SURF CITY). CONSTRUCT CONTINUOUS GREEN T-INTERSECTION (CGT). AT US 17 AND NC 210 NEAR SURF CITY.	Pender	FY
Brandon Powers	DDRL	R-5850	CFRPO	NC 53 PENDER COUNTY FROM US 117 BYPASS TO STAG PARK ROAD. WIDEN TO THREE LANES.	Pender	FY

Trace Howell	DDRL	R-5947	CFRPO	NC 211 FROM SR 1112 (SUNSET HARBOR ROAD) TO NC 906 (MIDWAY ROAD). WIDEN ROADWAY.	Brunswick	FY
--------------	------	--------	-------	---	-----------	----

Update provided: 09.24.24

PO: CFRPO

Contact: Michelle Howes, mnhowes@ncdot.gov, 910.341.2001 OR

*dates are subject to change

CFRPO SEPTEMBER PROJECTS UNDER CONSTRUCTION

Contract Number	Resident	TIP/WBS/ Program	County	Description	*Estimated Completion	Percent Complete
C204629	Joshua Pratt	B-5624	Brunswick	BRIDGE 57 OVER DRIVING CREEK ON NC-211.	2024.04.24	93.58%
C204435	Daniel Waugh	B-5644	Pender	BRIDGE 15 OVER CROOKED RUN ON NC-11.	2024.11.12	99.00%
C204123	Joshua Pratt	R-5021	Brunswick	NC 211 FROM SR 1500 (MIDWAY ROAD) TO NC 87 GRADING, DRAINAGE, PAVING, SIGNALS & STRUCTURES.	2027.12.03	48.41%
DC00337	Joshua Pratt	W-5703Q	Brunswick	NC 130 AT SR 1321 (LONGWOOD ROAD) & SR 1330 (WACCAMAW SCHOOL ROAD).	2024.08.30	74.68%
C204724	Daniel Waugh	B-5156	Pender	REPLACE BRIDGE 28 OVER LONG CREEK ON NC 210.	2026.03.03	16.01%

*dates are subject to change

CFRPO SEPTEMBER RESURFACING AND MAINTENANCE PROJECTS

Contract Number	TIP Number	County	Routes	*Estimated Completion Date	Percent Complete
C204720	I-6040	Pender	I-40 FROM WEST OF US-117 (MM-388) TO NC-210 (MM-408).	2024.08.02	100.00%
C204964	n/a	Brunswick	1 SECTION OF NC-87, AND 8 SECTIONS OF SECONDARY ROADS.	2026.05.01	0.00%
DC00428	n/a	Pender	NC 50, NC 53, & VARIOUS SECONDARY ROUTES.	2024.09.25	79.16%
C204556	HO-0002C	Brunswick	BROADBAND FIBER; US-70 FROM I-40 TO MOREHEAD CITY PORT, I-95 FROM SC STATE LINE TO VA STATE LINE, US-74 FROM ASHEVILLE TO WILMINGTON.	2027.07.31	72.31%
DC00431	n/a	Brunswick	NC 130 & VARIOUS SECONDARY ROUTES.	2024.08.30	52.66%
C204924	n/a	Pender	1 SECTION OF NC-53, 10 SECTIONS OF SECONDARY ROADS, AND 11 S ECTIONS OF NON-SYSTEM ROADS.	2025.10.31	0.00%
DC00438	n/a	Pender	NC 50 AND VARIOUS SECONDARY ROUTES	2024.10.24	90.96%

*dates are subject to change

Public Info Map for Resurfacing Projects: [NCDOT GO!NC Portal](https://ncdot.maps.arcgis.com/apps/mapviewer/index.html?webmap=441c2ce81ebf42faa77f3e47f5e6a97e)

<https://ncdot.maps.arcgis.com/apps/mapviewer/index.html?webmap=441c2ce81ebf42faa77f3e47f5e6a97e>

Division 6 Project Report October 2024



CAPE FEAR
COUNCIL OF GOVERNMENTS

Cape Fear RPO
Brunswick County ♦ Columbus County ♦ Pender County

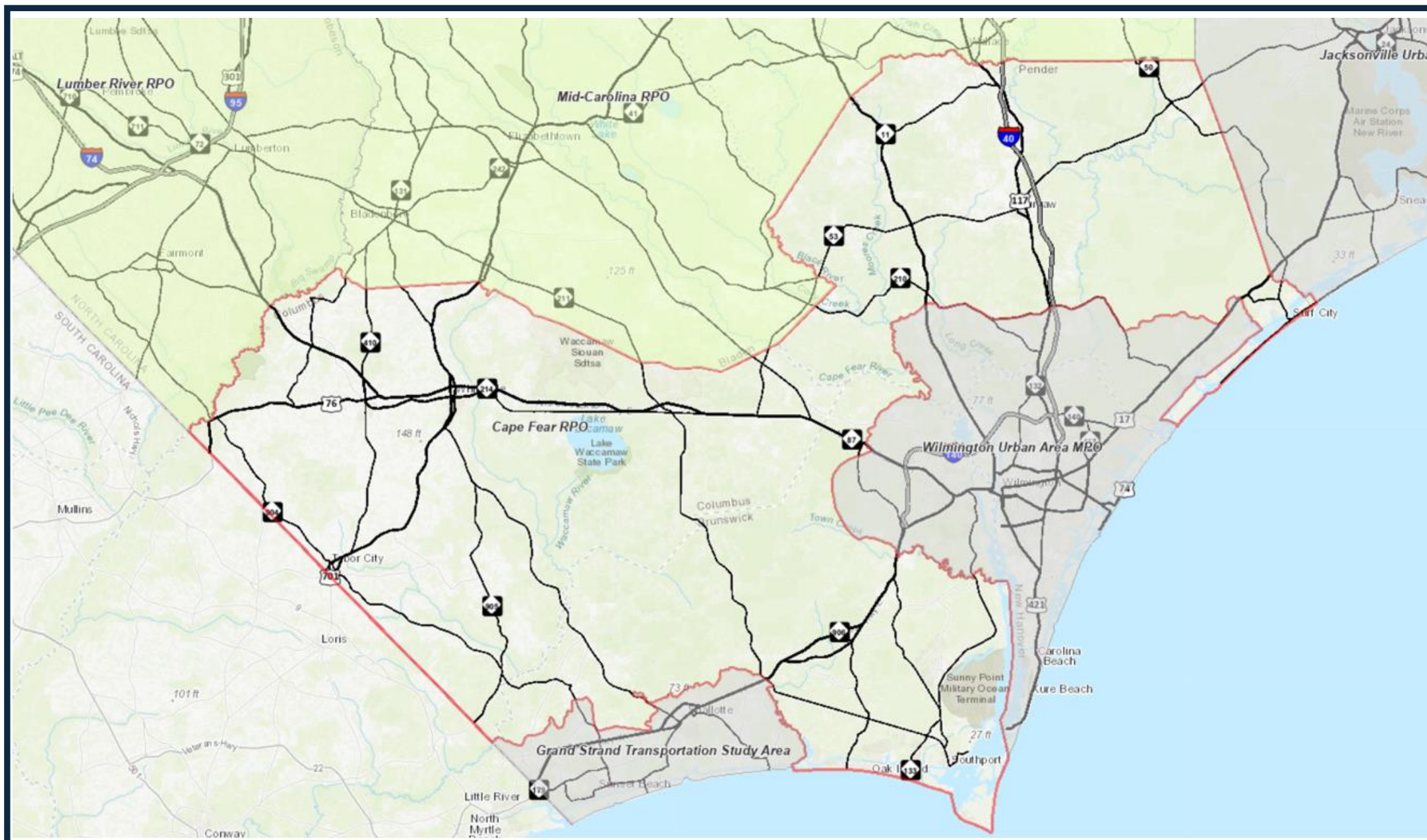

NCDOT, District 3 - Columbus County

TIP PROJECT: R-2561CA

CONTRACT: C204570

See Sheet 1A For Index of Sheets
See Sheet 1B For Conventional Symbols
See Sheet RW01 Thru RW13 For Right of Way Plan Streets

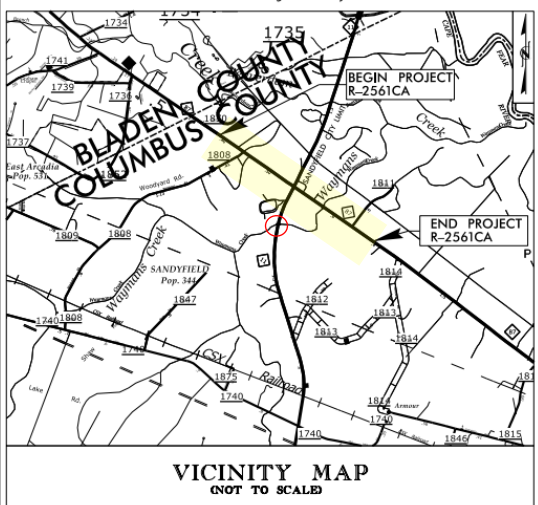

STATE OF NORTH CAROLINA
DIVISION OF HIGHWAYS
COLUMBUS COUNTY

LOCATION: NC 87 (OLD STAGE RD.)/NC 11 (GENERAL HOWE RD.) INTERCHANGE
TYPE OF WORK: GRADING, DRAINAGE, PAVING, AND STRUCTURES

STATE	STATE PROJECT REFERENCE NO.	SHEET NO.	TOTAL SHEETS
N.C.	R-2561CA	1	
STATE PROJ. NO.	F.A. PROJ. NO.	DESCRIPTION	
34466.4.5	N/A	P.E.	
34466.3.8	N/A	RW & UTILITIES	
34466.1.5	0087051	CONST.	

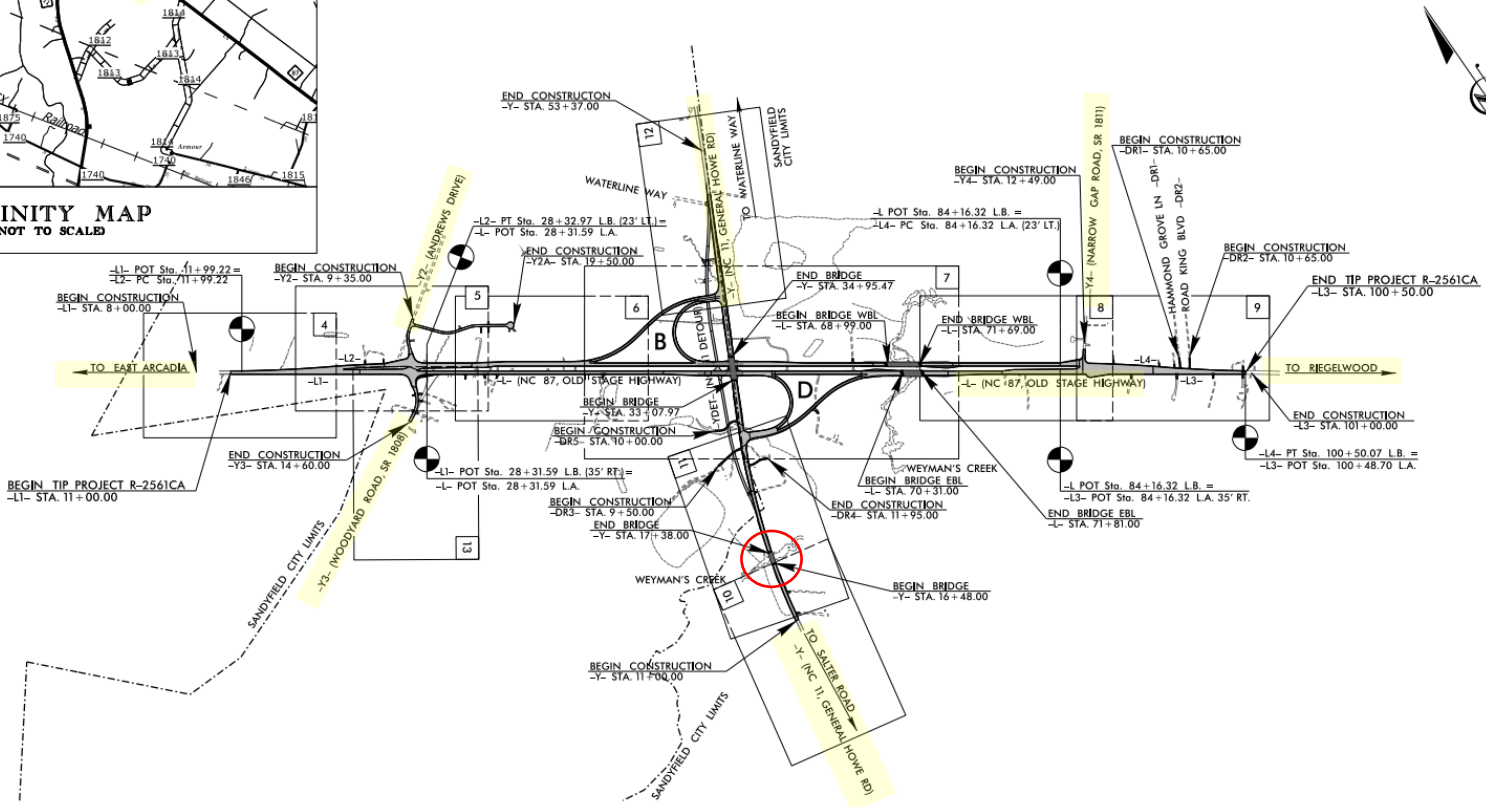

NTS

THIS IS A PARTIAL CONTROLLED-ACCESS PROJECT WITH ACCESS BEING LIMITED TO POINTS AS SHOWN ON THE PLANS.

DOCUMENT NOT CONSIDERED FINAL
UNLESS ALL SIGNATURES COMPLETED

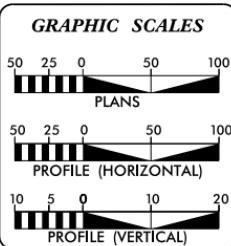

DESIGN DATA

ADT 2022 =	7364
ADT 2040 =	9000
K =	9 %
D =	60 %
T =	24 % *
V =	60 MPH
* TTST =	20% DUAL = 4%
FUNC CLASS =	MINOR ARTERIAL "REGIONAL TIER"

PROJECT LENGTH

LENGTH OF ROADWAY TIP PROJECT R-2561CA =	1.644 MILES
LENGTH OF STRUCTURE TIP PROJECT R-2561CA =	0.051 MILES
TOTAL LENGTH OF TIP PROJECT R-2561CA =	1.695 MILES

PLANS PREPARED FOR THE NCDOT BY:

SEPI
A Division of Transystems

2018 STANDARD SPECIFICATIONS

RIGHT OF WAY DATE:
OCTOBER 28, 2019.

LETTING DATE:
MAY 16, 2023

RAJAT RAMKUMAR, PE, LEED AP
PROJECT ENGINEER

DANIEL W. GARDNER, JR., PE
PROJECT DESIGN ENGINEER

JOHN B. GAUTHIER
NCDOT CONTACT

HYDRAULICS ENGINEER

ROADWAY DESIGN ENGINEER

Professional Engineer Seal: Rajat Ramkumar, PE, License No. 035621

Professional Engineer Seal: Daniel W. Gardner, PE, License No. 033871



Project Details:

Work Begin: 09/2023

Est. Completion: 11/2026

Rev. Completion: N/A

Contractor: Balfour Beatty

NCDOT Contact: Jason A. Johnson

Contract: \$35,978,896

Project Comments:

Utility relocation - in progress

NC 11 Bridge construction over Weyman's Creek has traffic detoured through Sandyfield. Bridge is expected to be closed until mid-October.

Reduced Conflict Intersections (RCI) at:

- Y2- Andrews Drive
- Y3- Woodyard Road
- Y4- Narrow Gap Road

CONSTRUCTION PROGRESS

26%

09/07/2024

See Sheet 1A for Index of Sheets
See Sheet 1B for Conventional Symbols

STATE OF NORTH CAROLINA
DIVISION OF HIGHWAYS

COLUMBUS COUNTY

LOCATION: US 701 BYPASS (MADISON STREET - JK POWELL BOULEVARD)
FROM SR 1437 (VIRGIL AVENUE) TO US 74/76

TYPE OF WORK: GRADING, DRAINAGE, PAVING, CULVERT, AND SIGNALS

STATE	STATE PROJECT REFERENCE NO.	SHEET NO.	TOTAL SHEETS
N.C.	R-5020B	1	
STATE PROJ. NO.	P.A. PROJ. NO.	DESCRIPTION	
41499.1.3	NHP-0701(033)	P.E.	
41499.2.3	N.A.	RW	
41499.2.5	N.A.	UTIL.	
41499.3.3	N.A.	CONST.	

Project Details:

Work Begin: 09/2021
Est. Completion: 12/2025
Rev. Completion: N/A
Contractor: Highland Paving
NCDOT Contact: Jason A. Johnson
Contract: \$28,249,248

TIP PROJECT: R-5020B

CONTRACT: C204649

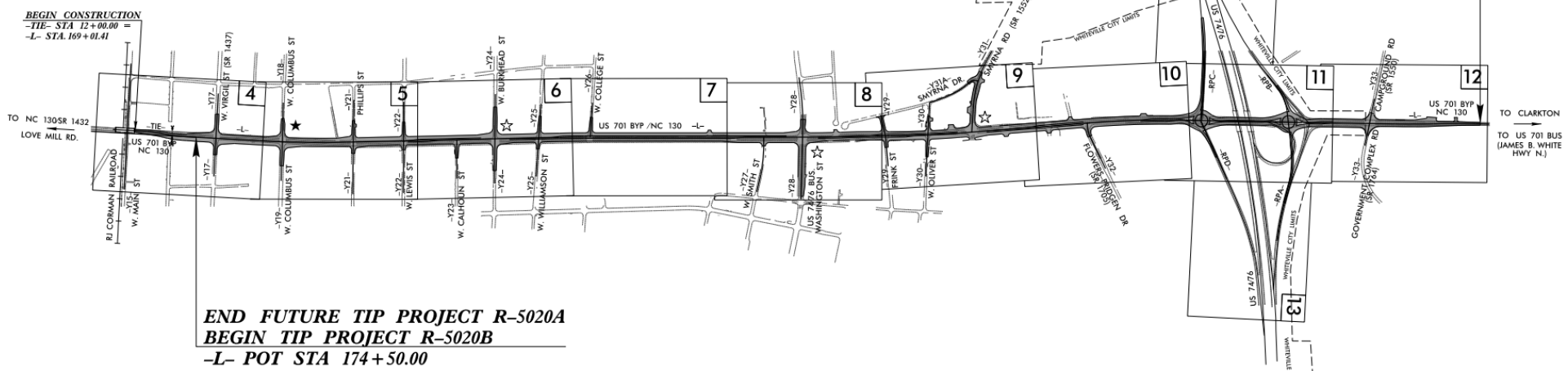
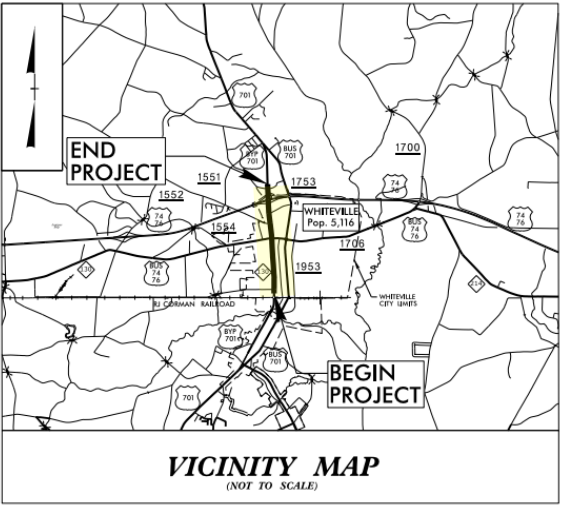

Project Comments:

- Full access intersections:
- US 74/76 Bus. (Washington St.)
 - W Columbus Street
 - Burkhead Street
 - Smyrna Road & Drive
- RCI Intersections (3/4 access):
- Virgil Street
 - Philips Street
 - Flowers-Pridgen Drive
 - Campground / Gov. Complex Road
- Right in / Right out:
- Lewis Street
 - Calhoun Street
 - Williams Street
 - Frink Street
 - Oliver Street
 - W College Street
 - W Smith Street
 - Liberty Street

**CONSTRUCTION
PROGRESS**

79%

08/31/2024

NTS

NOTE:
1. THIS IS A PARTIAL CONTROLLED-ACCESS PROJECT WITH ACCESS BEING LIMITED TO POINTS AS SHOWN ON THE PLANS.

GRAPHIC SCALES

50 25 0 50 100
PLANS

50 25 0 50 100
PROFILE (HORIZONTAL)

10 5 0 10 20
PROFILE (VERTICAL)

DESIGN DATA

ADT 2020 = 21,417
ADT 2040 = 26,000
K = 8 %
D = 55 %
T = 6 %
V = 50 MPH
*(TTST = 3% + DUAL 3%)

FUNC CLASS = URBAN ARTERIAL
REGIONAL TIER

PROJECT LENGTH

LENGTH OF ROADWAY TIP PROJECT R-5020B = 2.183 MILES

TOTAL LENGTH OF TIP PROJECT R-5020B = 2.183 MILES

Prepared In the Office of:
KCI Associates of N.C., P.A.
4505 Falls of Neuse Road, Suite 400
Raleigh, NC 27609
Phone (919) 783-9214
Fax (919) 783-4266

Plans Prepared For:
DIVISION OF HIGHWAYS
558 Gillespie St.
Fayetteville NC, 28301

2018 STANDARD SPECIFICATIONS

RIGHT OF WAY DATE:
FEBRUARY 16, 2018

LETTING DATE:
AUGUST 17, 2021

NCDOT CONTACT: **CRAIG A. FREEMAN, P.E.**
PROJECT ENGINEER - DIVISION 6

HYDRAULICS ENGINEER

Developed by:
John G. Dillen
SIGNATURE: 5/5/2021

ROADWAY DESIGN ENGINEER

Developed by:
Barry C. Smith
SIGNATURE: 5/5/2021

SUNGATE DESIGN GROUP, P.A.

DOCUMENT NOT CONSIDERED FINAL UNLESS ALL SIGNATURES COMPLETED

STATE OF NORTH CAROLINA
DEPARTMENT OF TRANSPORTATION

PROJECT: HB-0011

CONTRACT: C204713

See Sheet 1-A For Index of Sheets

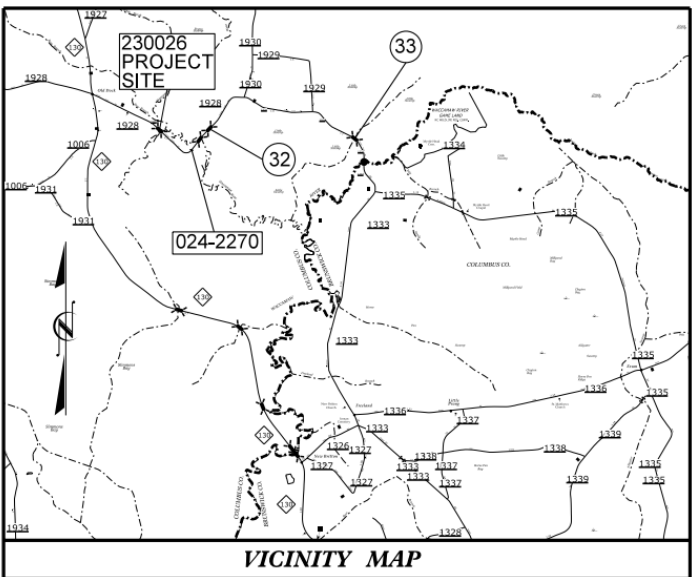

STATE OF NORTH CAROLINA
DIVISION OF HIGHWAYS
COLUMBUS COUNTY

LOCATION: BRIDGE# 230026 OVER GUM SWAMP RUN
ON SR 1928 (DOCK ROAD)

TYPE OF WORK: GRADING, DRAINAGE, PAVING & STRUCTURE

STATE	N.C.	STATE PROJECT REFERENCE NO.	HB-0011	SHEET NO.	1	TOTAL SHEETS	
STATE PROJ. NO.	49872.3.1	F.A. PROJ. NO.		DESCRIPTION	PE		
	49872.3.1				UTIL., R/W		
	49872.3.1				CONST.		



Project Details:
 Work Begin: 05/2022
 Est. Completion: 05/2024
 Rev. Completion: 12/2024
 Contractor: S & C Construction
 NCDOT Contact: Jason A. Johnson
 Contract: \$5,068,921*

Project Comments:
 1 of 4 structures in the contract*
 This bridge project is completed, except for final layer of asphalt.

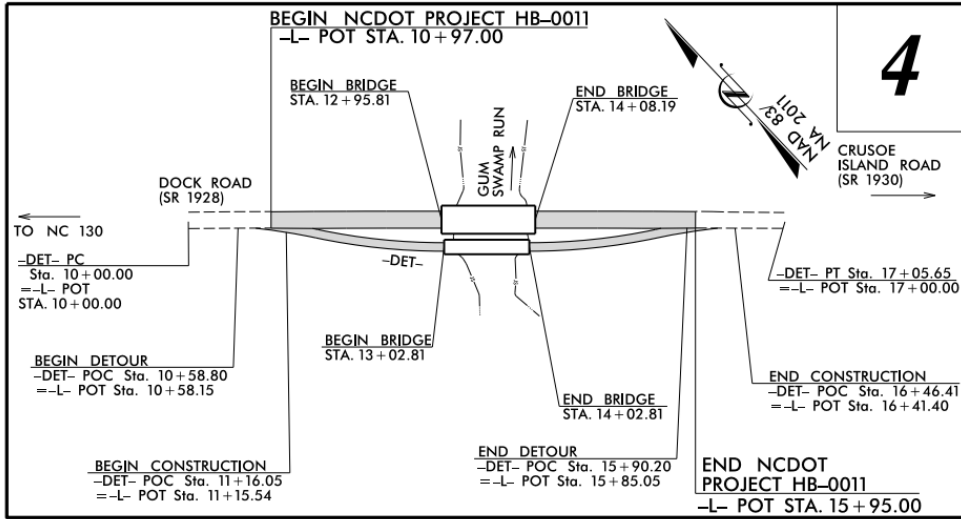

NTS

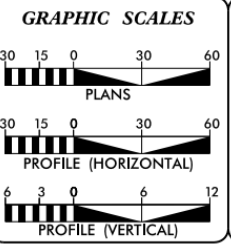

DESIGN DATA

ADT 2022 =	880
ADT FY =	N/A
DHV =	N/A
D =	N/A
T =	6 % *
V =	55 MPH
* (TTST = 3% + DUAL = 3%)	
FUNC CLASS =	
LOCAL REGIONAL TIER	

PROJECT LENGTH

LENGTH ROADWAY PROJECT HB-0011 =	0.073 MILES
LENGTH STRUCTURE PROJECT HB-0011 =	0.021 MILES
TOTAL LENGTH PROJECT HB-0011 =	0.094 MILES

NCDOT CONTACT: JESS EARLEY, PE
PRIORITY PROJECTS UNIT

Prepared for:
DIVISION OF HIGHWAYS
1000 BIRCH RIDGE DRIVE, RALEIGH, NC 27610

2018 STANDARD SPECIFICATIONS

RIGHT OF WAY DATE: EDWARD G. WETHERILL, PE
MARCH 15, 2022
PROJECT ENGINEER

LETTING DATE: GREG S. PURVIS, PE
MARCH 15, 2022
PROJECT DESIGN ENGINEER

HYDRAULICS ENGINEER
9/6/2022

ROADWAY DESIGN ENGINEER
9/6/2022

Professional Engineer seals for Edward G. Wetherill, PE and Greg S. Purvis, PE.



CONSTRUCTION PROGRESS

86%

08/22/2024

STATE OF NORTH CAROLINA
DIVISION OF HIGHWAYS

COLUMBUS COUNTY

LOCATION: BRIDGE# 230032 OVER OVERFLOW FOR WACCAMAW RIVER
ON SR 1928 (DOCK ROAD)

TYPE OF WORK: GRADING, DRAINAGE, PAVING & STRUCTURE

STATE	STATE PROJECT REFERENCE NO.	SHEET NO.	TOTAL SHEETS
N.C.	HB-0012	1	
STATE PROJ. NO.	F.A. PROJ. NO.	DESCRIPTION	
49872.3.1		PE	
49872.3.1		UTIL., R/W	
49872.3.1		CONST.	



WETHERILL ENGINEERING
1223 Jones Franklin Rd.
Raleigh, N.C. 27606
License No. F-0377
Bus: 919 851 8077
Fax: 919 851 8107

TRANSPORTATION PLANNING/DESIGN - BRIDGE/STRUCTURE DESIGN
CIVIL/SITE DESIGN - GIS/GPS - CONSTRUCTION OBSERVATION

BRIDGE# 230032

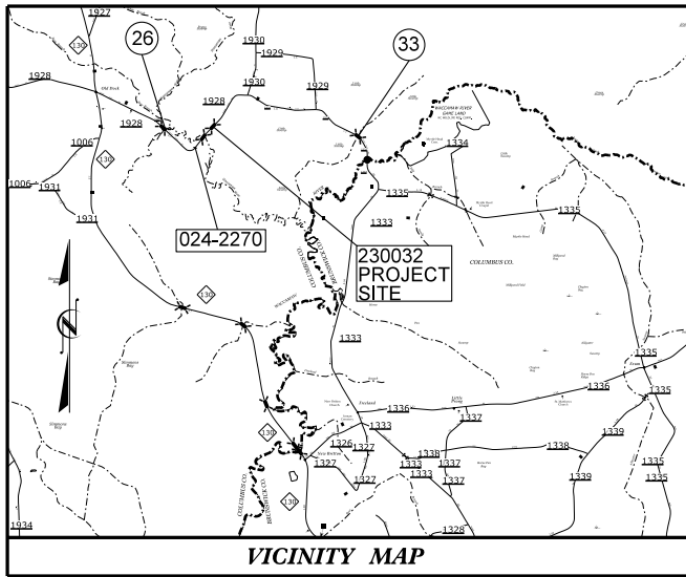

VICINITY MAP

EXPRESS DESIGN BRIDGE REPLACEMENT: DIVISION 6

RFC PLANS

BRIDGE #: 230032
SUBMITTAL #: B-008R1
SUBMITTAL DATE: 9/7/22

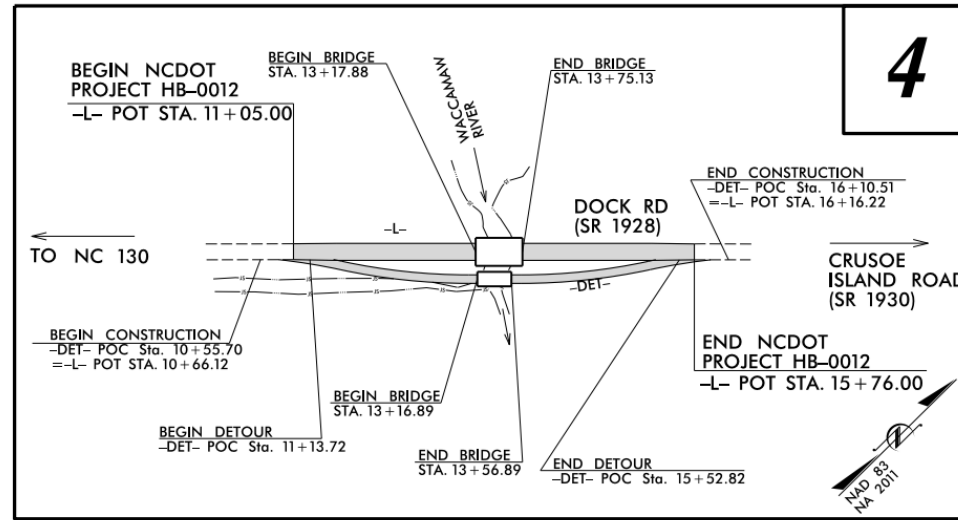

4
RELEASE FOR CONSTRUCTION
DATE: 9/6/2022

NTS

PROJECT: HB-0012

CONTRACT: C204713

Project Details:

Work Begin: 05/2022
Est. Completion: 05/2024
Rev. Completion: 12/2024
Contractor: S & C Construction
NCDOT Contact: Jason A. Johnson
Contract: \$5,068,921*

Project Comments:

2 of 4 structures in the contract*
This bridge project is completed, except for final layer of asphalt.

CONSTRUCTION PROGRESS

86%

08/22/2024

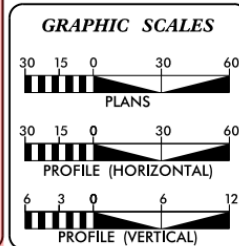

DESIGN DATA

ADT 2022 = 880
ADT FY = N/A
DHV = N/A
D = N/A
T = 6 % *
V = 55 MPH
* (TTST = 3% + DUAL = 3%)
FUNC CLASS =
LOCAL REGIONAL TIER

PROJECT LENGTH

LENGTH ROADWAY PROJECT HB-0012 = 0.079 MILES
LENGTH STRUCTURE PROJECT HB-0012 = 0.010 MILES
TOTAL LENGTH PROJECT HB-0012 = 0.089 MILES

NCDOT CONTACT: JESS EARLEY, PE
PRIORITY PROJECTS UNIT

Prepared for:
DIVISION OF HIGHWAYS
1000 BIRCH RIDGE DRIVE, RALEIGH, NC 27610

2018 STANDARD SPECIFICATIONS

RIGHT OF WAY DATE: EDWARD G. WETHERILL, PE
MARCH 15, 2022
PROJECT ENGINEER

LETTING DATE: GREG S. PURVIS, PE
MARCH 15, 2022
PROJECT DESIGN ENGINEER

HYDRAULICS ENGINEER
9/6/2022

Professional Seal: John G. Delle, P.E.
SIGNATURE: _____

ROADWAY DESIGN ENGINEER
9/6/2022

Professional Seal: Greg S. Purvis, P.E.
SIGNATURE: _____



DOCUMENT NOT CONSIDERED FINAL UNLESS ALL SIGNATURES COMPLETED

PROJECT: HB-0013

CONTRACT: C204713

See Sheet 1-A For Index of Sheets

STATE OF NORTH CAROLINA DIVISION OF HIGHWAYS COLUMBUS COUNTY

LOCATION: BRIDGE #230421 OVER OVERFLOW FOR WACCAMAW RIVER
FLOODPLAIN ON SR 1928 (DOCK ROAD)

TYPE OF WORK: GRADING, DRAINAGE, PAVING & STRUCTURE

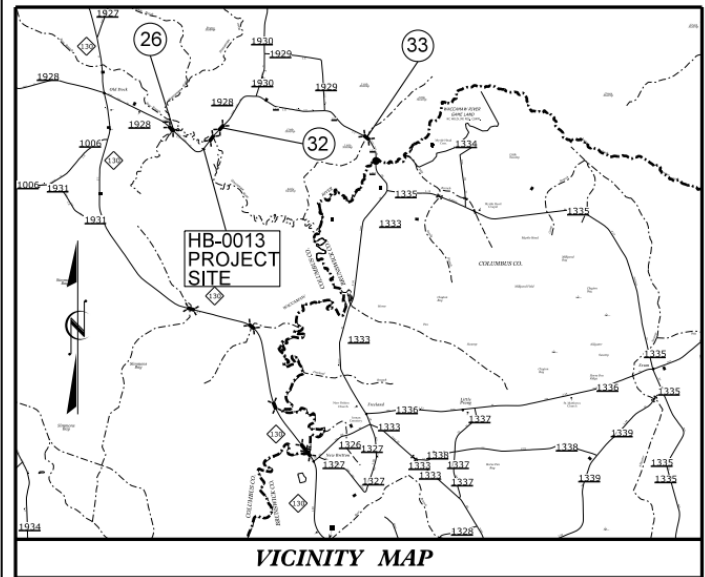

VICINITY MAP

STATE	STATE PROJECT REFERENCE NO.	SHEET NO.	TOTAL SHEETS
N.C.	HB-0013	1	
STATE PROJ. NO.	F.A. PROJ. NO.	DESCRIPTION	
49872.3.1		PE	
49872.3.1		UTIL, RW	
49872.3.1		CONST.	



WETHERILL ENGINEERING
1223 Jones Franklin Rd.
Raleigh, N.C. 27606
License No. F-0377
Bus: 919 851 8077
Fax: 919 851 8107

TRANSPORTATION PLANNING/DESIGN - BRIDGE/STRUCTURE DESIGN
CIVIL/SITE DESIGN - GIS/GPS - CONSTRUCTION OBSERVATION

BRIDGE # 230421

EXPRESS DESIGN BRIDGE REPLACEMENT: DIVISION 6

RFC PLANS

BRIDGE #: 2300421
SUBMITTAL #: C-006RI
SUBMITTAL DATE: 8/23/22

RELEASE FOR CONSTRUCTION
DATE: 9/6/2022

DOCUMENT NOT CONSIDERED FINAL UNLESS ALL SIGNATURES COMPLETED

DESIGN EXCEPTION REQUIRED FOR THE HORIZONTAL ALIGNMENT (HORIZONTAL CURVE RADIUS AND HORIZONTAL STOPPING SIGHT DISTANCE)

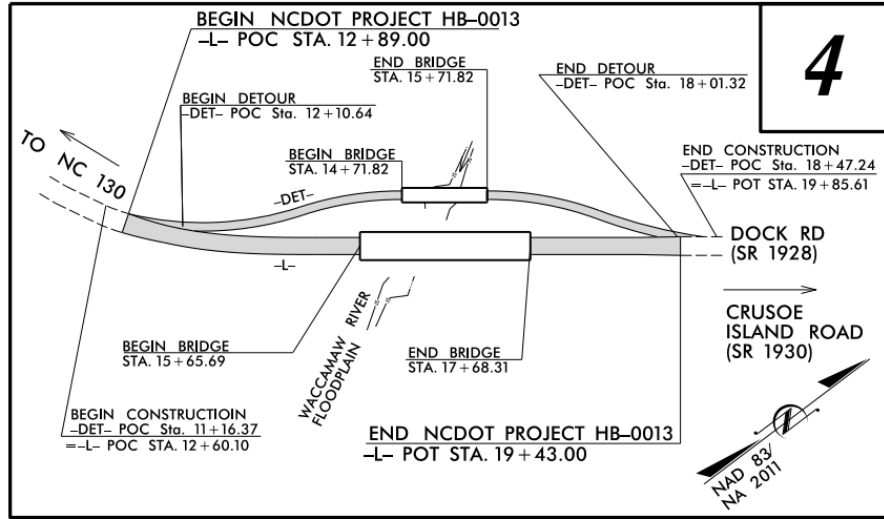

NTS

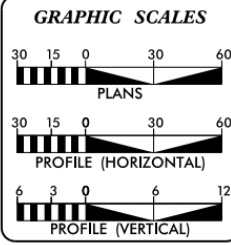

DESIGN DATA

ADT 2022 = 880
ADT FY = N/A
DHV = N/A
D = N/A
T = 6 % *
V = 55 MPH
* (TTST = 3% + DUAL = 3%)
FUNC CLASS =
LOCAL REGIONAL TIER

PROJECT LENGTH

LENGTH ROADWAY PROJECT HB-0013 = 0.086 MILES
LENGTH STRUCTURE PROJECT HB-0013 = 0.038 MILES
TOTAL LENGTH PROJECT HB-0013 = 0.124 MILES

NCDOT CONTACT: JESS EARLEY, PE
PRIORITY PROJECTS UNIT

Prepared for:
DIVISION OF HIGHWAYS
1000 BIRCH RIDGE DRIVE, RALEIGH, NC 27610

2018 STANDARD SPECIFICATIONS

RIGHT OF WAY DATE: EDWARD G. WETHERILL, PE
MARCH 15, 2022
PROJECT ENGINEER

LETTING DATE: GREG S. PURVIS, PE
MARCH 15, 2022
PROJECT DESIGN ENGINEER

HYDRAULICS ENGINEER
9/6/2022

ROADWAY DESIGN ENGINEER
9/6/2022

SEAL 26971
EDWARD G. WETHERILL, PE

SEAL 022999
GREG S. PURVIS, PE



Project Details:

Work Begin: 05/2022
Est. Completion: 05/2024
Rev. Completion: 12/2024
Contractor: S & C Construction
NCDOT Contact: Jason A. Johnson
Contract: \$5,068,921*

Project Comments:

3 of 4 structures in the contract*
This bridge project is under construction.

CONSTRUCTION PROGRESS

86%

08/22/2024

PROJECT: HB-0014

CONTRACT: C204713

See Sheet 1-A For Index of Sheets

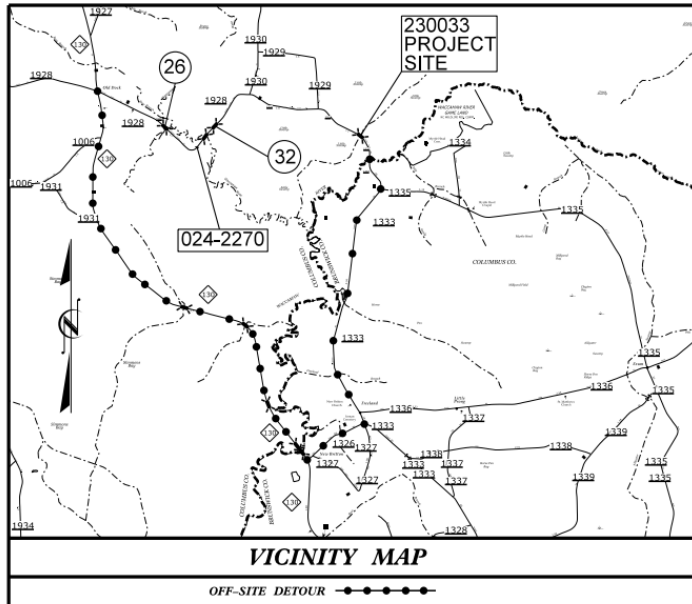

STATE OF NORTH CAROLINA
DIVISION OF HIGHWAYS

COLUMBUS COUNTY

LOCATION: BRIDGE NO. 230033 OVER OVERFLOW TO JUNIPER CREEK
ON SR 1928 (DOCK ROAD)

TYPE OF WORK: GRADING, DRAINAGE, PAVING & STRUCTURE

STATE	STATE PROJECT REFERENCE NO.	SHEET NO.	TOTAL SHEETS
N.C.	HB-0014	1	
STATE PROJ. NO.	F.A. PROJ. NO.	DESCRIPTION	
49872.3.1		PE	
49872.3.1		UTIL., RAW	
49872.3.1		CONST.	

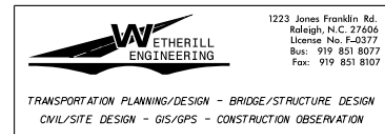

Project Details:

Work Begin: 05/2022
Est. Completion: 05/2024
Rev. Completion: 12/2024
Contractor: S & C Construction
NCDOT Contact: Jason A. Johnson
Contract: \$5,068,921*

Project Comments:

4 of 4 structure in the contract*
This bridge project is under construction with detour route through part of Brunswick County.

EXPRESS DESIGN BRIDGE REPLACEMENT: DIVISION 6

RFC PLANS

BRIDGE #: 230033
SUBMITTAL #: D-013
SUBMITTAL DATE: 11/14 /22

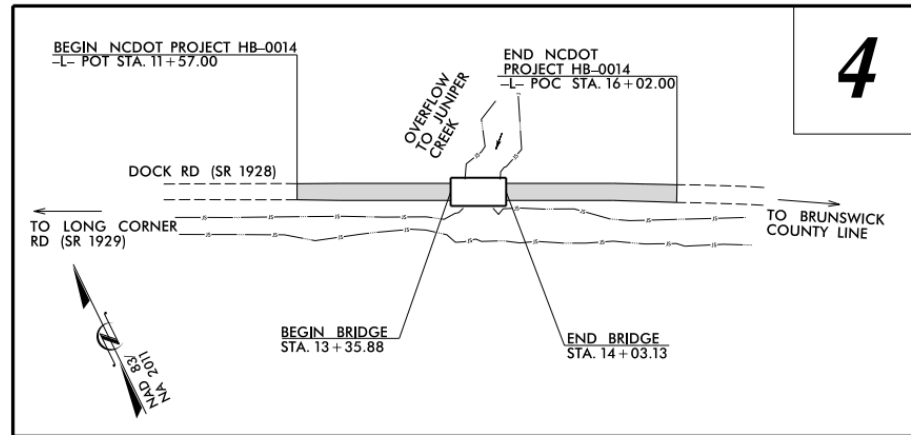

NTS

RELEASE FOR CONSTRUCTION
DATE: 2/19/2024

DOCUMENT NOT CONSIDERED FINAL
UNLESS ALL SIGNATURES COMPLETED

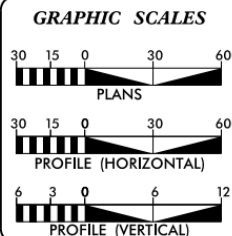

DESIGN DATA

ADT 2022 = 880
ADT FY = N/A
DHV = N/A
D = N/A
T = 6 % *
V = 55 MPH
* (TTST = 3% + DUAL = 3%)
FUNC CLASS = LOCAL REGIONAL TIER

PROJECT LENGTH

LENGTH ROADWAY PROJECT HB-0014 = 0.071 MILES
LENGTH STRUCTURE PROJECT HB-0014 = 0.013 MILES
TOTAL LENGTH PROJECT HB-0014 = 0.084 MILES

NCDOT CONTACT: JESS EARLEY, PE
PRIORITY PROJECTS UNIT

Prepared for:
DIVISION OF HIGHWAYS
1000 BIRCH RIDGE DRIVE, RALEIGH, NC 27610

2018 STANDARD SPECIFICATIONS

RIGHT OF WAY DATE: MARCH 15, 2022

LETTING DATE: MARCH 15, 2022

EDWARD G. WETHERILL, PE
PROJECT ENGINEER

GREG S. PURVIS, PE
PROJECT DESIGN ENGINEER

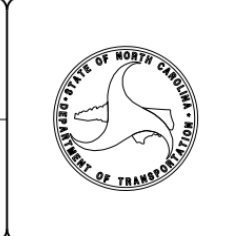
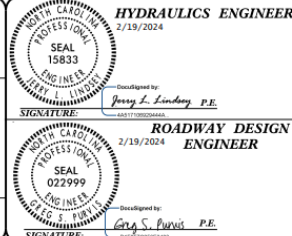

CONSTRUCTION PROGRESS

86%

08/22/2024

CONTRACT: R-5819/R-5820

TIP PROJECT: C204722

See Sheet 1A For Index of Sheets
See Sheet 1B For Conventional Plan Sheet Symbols

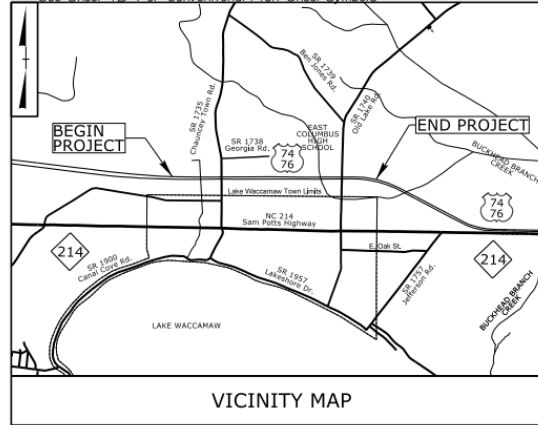

STATE OF NORTH CAROLINA DIVISION OF HIGHWAYS COLUMBUS COUNTY

**LOCATION: US 74/US 76 AT SR 1735 (CHAUNCEY TOWN ROAD)
CONVERT AT-GRADE INTERSECTION TO INTERCHANGE (COMBINE W/R-5819)
US 74/US 76 AT SR 1740(OLD LAKE ROAD)
CONVERT AT-GRADE INTERSECTION TO OVERPASS (COMBINE W/R-5820)**

TYPE OF WORK: GRADING, PAVING, DRAINAGE, STRUCTURES

STATE	STATE PROJECT REFERENCE NO.	SHEET NO.	TOTAL SHEETS
N.C.	R-5819/R-5820	1	
STATE WBS NO.	F.A. PROGRAM	DESCRIPTION	
47091.1/47092.1.1		PE	
47092.2.1		ROW	
47092.2.2		UTIL	
47092.3.1		CONST	

BEGIN TIP PROJECT R-5819/R-5820
-LWB- POC STA. 18+50.00
-LEB- POC STA. 18+50.00

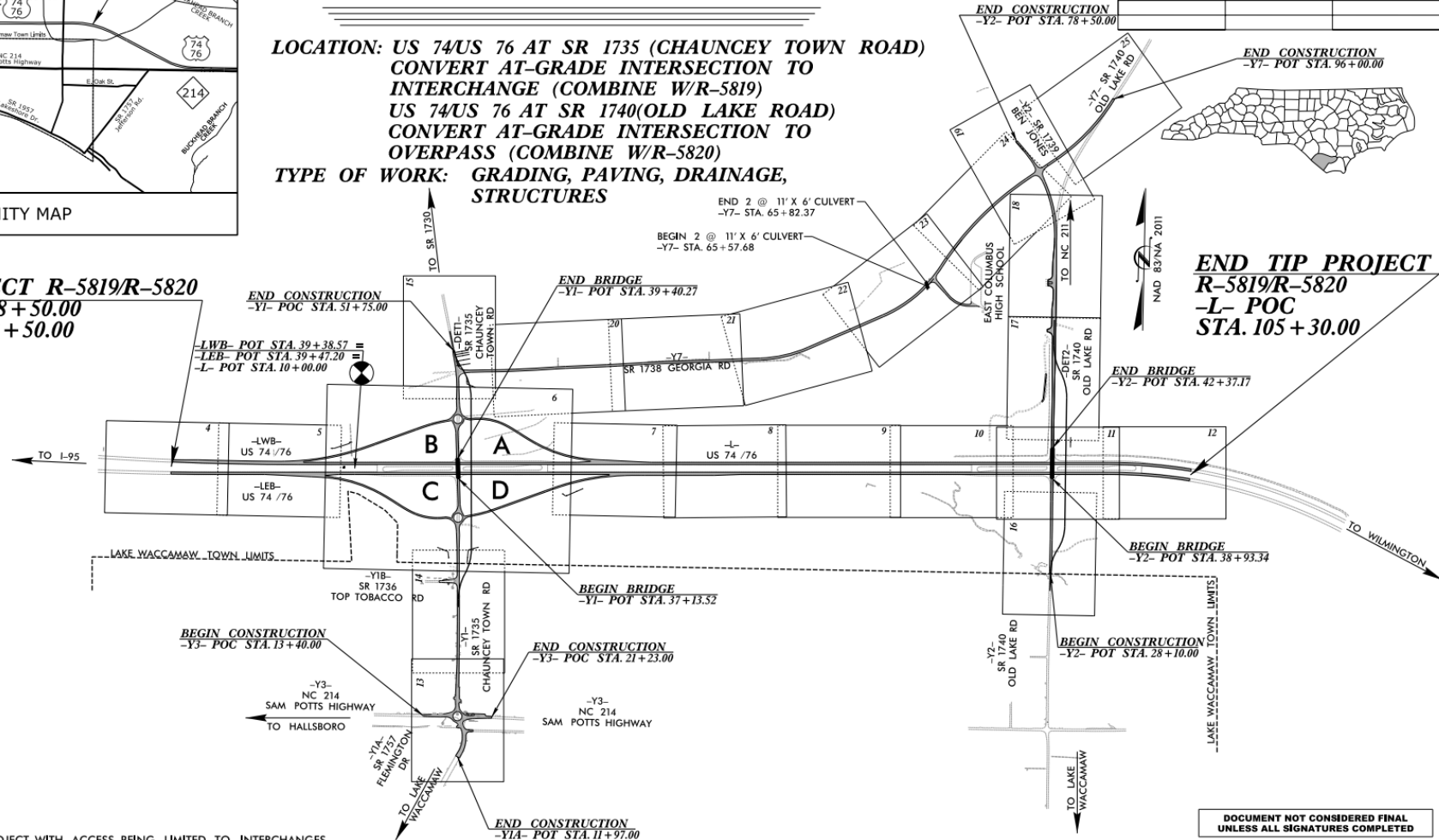

END TIP PROJECT R-5819/R-5820
-L- POC STA. 105+30.00

NTS

NOTES:
1. THIS IS A CONTROLLED-ACCESS PROJECT WITH ACCESS BEING LIMITED TO INTERCHANGES.

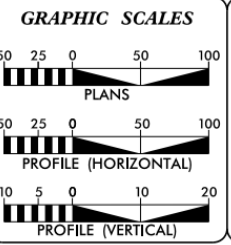

DESIGN DATA

ADT 2022 =	14,400
ADT 2042 =	18,000
K =	8 %
D =	55 %
T =	20 % *
V =	75 MPH
* 16% TTST + 4% DUAL	
FUNC CLASS=INTERSTATE STATEWIDE TIER	

PROJECT LENGTH

LENGTH ROADWAY TIP PROJECT R-5819/R-5820 =	2.202 MILES
TOTAL LENGTH TIP PROJECT R-5819/R-5820 =	2.202 MILES

Prepared in the Office of:
NIV5
FOR THE NORTH CAROLINA DEPARTMENT OF TRANSPORTATION
2018 STANDARD SPECIFICATIONS

RIGHT OF WAY DATE:	JOHNNY BANKS -NIV5 PROJECT MANAGER MARCH 22, 2021
LETTING DATE:	STEVE A. DRUM, PE -NIV5 PROJECT DESIGN ENGINEER JUNE 21, 2022
	JOHN GAUTHIER -NCDOT PROJECT MANAGER

HYDRAULICS ENGINEER

Developed by: Brandon Barkan
SIGNATURE: [Signature] P.E. 4/13/2022

ROADWAY DESIGN ENGINEER

Developed by: Steve Anthony Drum
SIGNATURE: [Signature] P.E. 4/13/2022



Project Details:

Work Begin: 08/2022
Est. Completion: 01/2026
Rev. Completion: N/A

Contractor: BMCO Construction

NCDOT Contact: Jason A. Johnson

Contract: \$44,098,712

Project Comments:

Bridge girders set on -Y1- SR 1735 (Chauncey Town Road) and -Y2- SR 1740 (Old Lake Road).

Ramp earthwork is complete. Ramp pavement is at 75%.

Chaunceytown Road widening and roundabout construction is underway.

Project is ahead of schedule.

CONSTRUCTION PROGRESS

71%

08/15/2024

CONTRACT: C204912

TIP PROJECT: HI-0015

STATE OF NORTH CAROLINA
DIVISION OF HIGHWAYS

COLUMBUS COUNTY

LOCATION: US 74 (FUTURE I-74) FROM WEST OF NC 214
TO WEST OF WATER TANK ROAD (SR 1824)

TYPE OF WORK: PAVEMENT & STRUCTURES REHABILITATION & DRAINAGE

STATE	STATE PROJECT REFERENCE NO.	PROJECT NO.	TOTAL BRIDGE
N.C.	HI-0015	1	
STATE PROJ. NO.	F.A. PROJ. NO.	DESCRIPTION	
49986.1.1	0074245	PE	
49986.3.1	0074245	CONST	



VICINITY MAP
N.T.S.

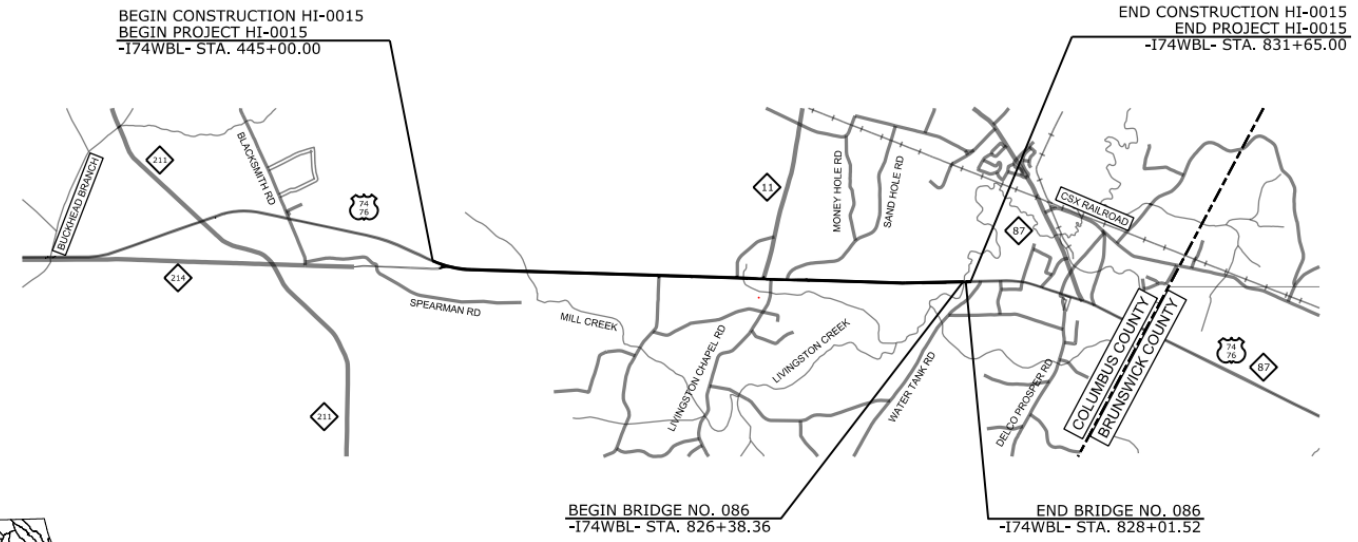

Project Details:

Work Begin: N/A

Est. Completion: 10/2025

Rev. Completion: N/A

Contractor: S. T. Wooten

NCDOT Contact: Jason A. Johnson

Contract: \$8,742,876

Project Comments:

Bridge rehab work at Livingston Creek has begun.

Pavement rehabilitation work is scheduled to begin September.

**CONSTRUCTION
PROGRESS**

7%

08/15/2024

DESIGN DATA
AADT 2021 = 17,000
V = 60 MPH

FUNC CLASS =
PRINCIPAL ARTERIAL

PROJECT LENGTH

LENGTH ROADWAY TIP PROJECT HI-0015 WBL = 7.292 MI
LENGTH STRUCTURE TIP PROJECT HI-0015 WBL = 0.031 MI
TOTAL LENGTH OF TIP PROJECT HI-0015 WBL = 7.323 MI

Prepared for the Office of:
DIVISION OF HIGHWAYS
431 Transportation Dr, Fayetteville NC, 28301

2024 STANDARD SPECIFICATIONS

RIGHT OF WAY DATE:
N/A

LETTING DATE:
FEBRUARY 20, 2024

ALEX HENDERSON
NCDOT CONTACT
PROJECT MANAGER

DOUGLAS SAUNDERS, PE
PROJECT ENGINEER

WILLIAM TILLITT, PE
PROJECT DESIGN ENGINEER

11/29/2023

DocuSigned by:
William E. Tillitt
SIGNATURE OF WILLIAM E. TILLITT, P.E.



CONTRACT: BP6.R004

CONTRACT: DF00464

See Sheet 1A For Index of Sheets
See Sheet 1B For Conventional Symbols

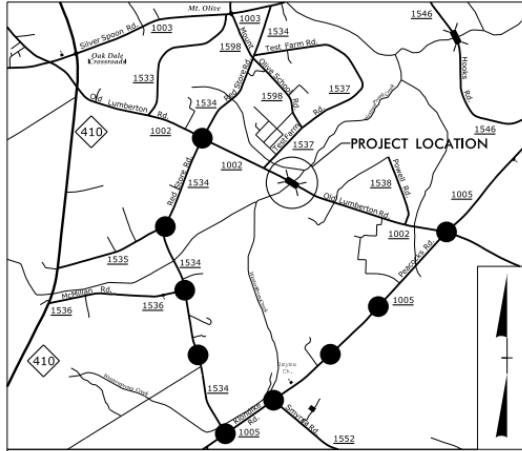

VICINITY MAP

● DETOUR ROUTE

STATE OF NORTH CAROLINA
DIVISION OF HIGHWAYS

COLUMBUS COUNTY

LOCATION: BRIDGE NO. 230201 ON OLD LUMBERTON ROAD (SR 1002) OVER
WESTERN PRONG CREEK.

TYPE OF WORK: GRADING, DRAINAGE, PAVING & STRUCTURE.

STATE	STATE PROJECT REFERENCE NO.	SHEET NO.	TOTAL SHEETS
N.C.	BP6.R004	1	
STATE PROJ. NO.	P.A. PROJ. NO.	DESCRIPTION	
BP6.R004.1	NA	PE	
BP6.R004.2	NA	ROW	
BP6.R004.3	NA	CONST.	

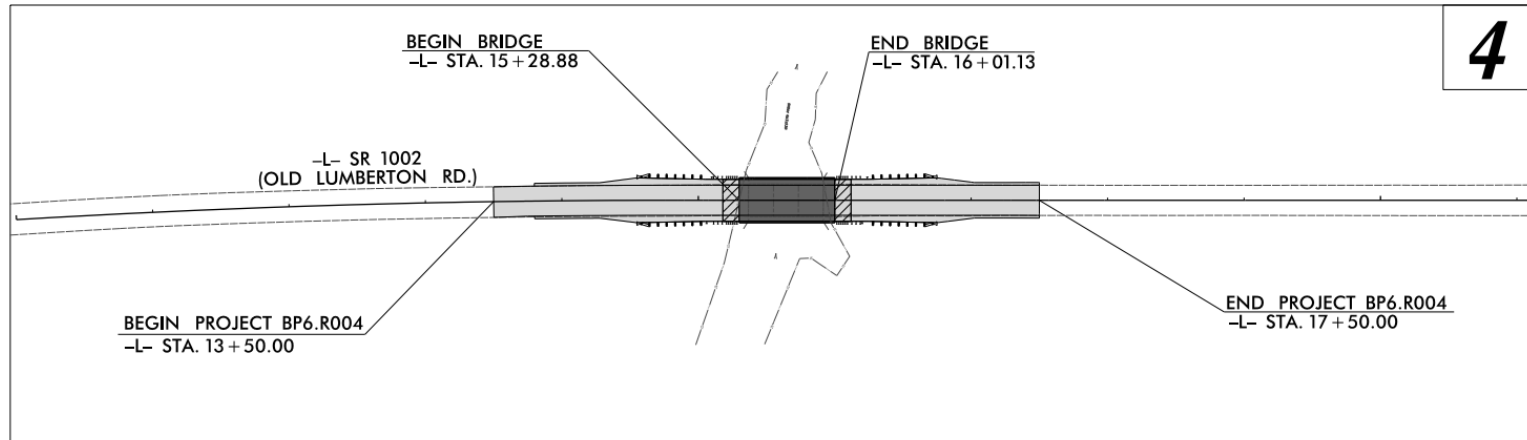
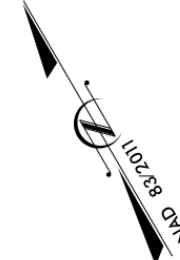

NTS

DOCUMENT NOT CONSIDERED FINAL
UNLESS ALL SIGNATURES COMPLETED

<p>GRAPHIC SCALES</p> <p>20 10 0 20 40 PLANS</p> <p>20 10 0 20 40 PROFILE (HORIZONTAL)</p> <p>4 2 0 4 8 PROFILE (VERTICAL)</p>	<p>DESIGN DATA</p> <p>ADT 2022 = 2600 ADT 2025 = 5200 V = 60 MPH * TTST = 6% FUNC CLASS = MINOR COLLECTOR SUB-REGIONAL TIER</p>	<p>PROJECT LENGTH</p> <p>LENGTH ROADWAY PROJECT = 0.062 MILES LENGTH STRUCTURE PROJECT = 0.014 MILES TOTAL LENGTH PROJECT = 0.076 MILES</p> <p>NC DOT CONTACT: ADAM BRITT DIV. 6 BRIDGE PROGRAM MANAGER</p>
---	--	---

Prepared in the Office of:
SUMMIT
DESIGN AND ENGINEERING SERVICES
300 EXHIBITOR CT.
HILLSBOROUGH, NC 27278-8651
Voice: (919) 732-3883
Fax: (919) 732-6776
www.summitde.com

2024 STANDARD SPECIFICATIONS

RIGHT OF WAY DATE:
JULY 1, 2022

LETTING DATE:
FEBRUARY 21, 2024

SPENCER W. MERRITT
PROJECT ENGINEER

FAITH E. JAHNKE, PE
PROJECT DESIGN ENGINEER

HYDRAULICS ENGINEER
1/16/2024

Seal: [Professional Engineer Seal]

ROADWAY DESIGN ENGINEER
1/16/2024

Seal: [Professional Engineer Seal]

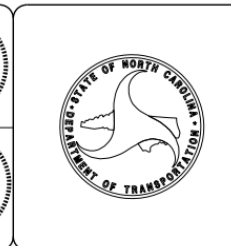

Project Details:

Work Begin: 04/2024

Est. Completion: 03/2025

Rev. Completion: N/A

Contractor: TARA Group

NC DOT Contact: Jason A. Johnson

Contract: \$627,909

Project Comments:

Non-STIP Bridge Project (BP)
Contract awarded 02/28/24.

Road closed on 7/16/24 to begin construction.

CONSTRUCTION PROGRESS

0%

09/16/2024

Columbus County Municipal Airport Apron Expansion

WBS: 46342.3.1

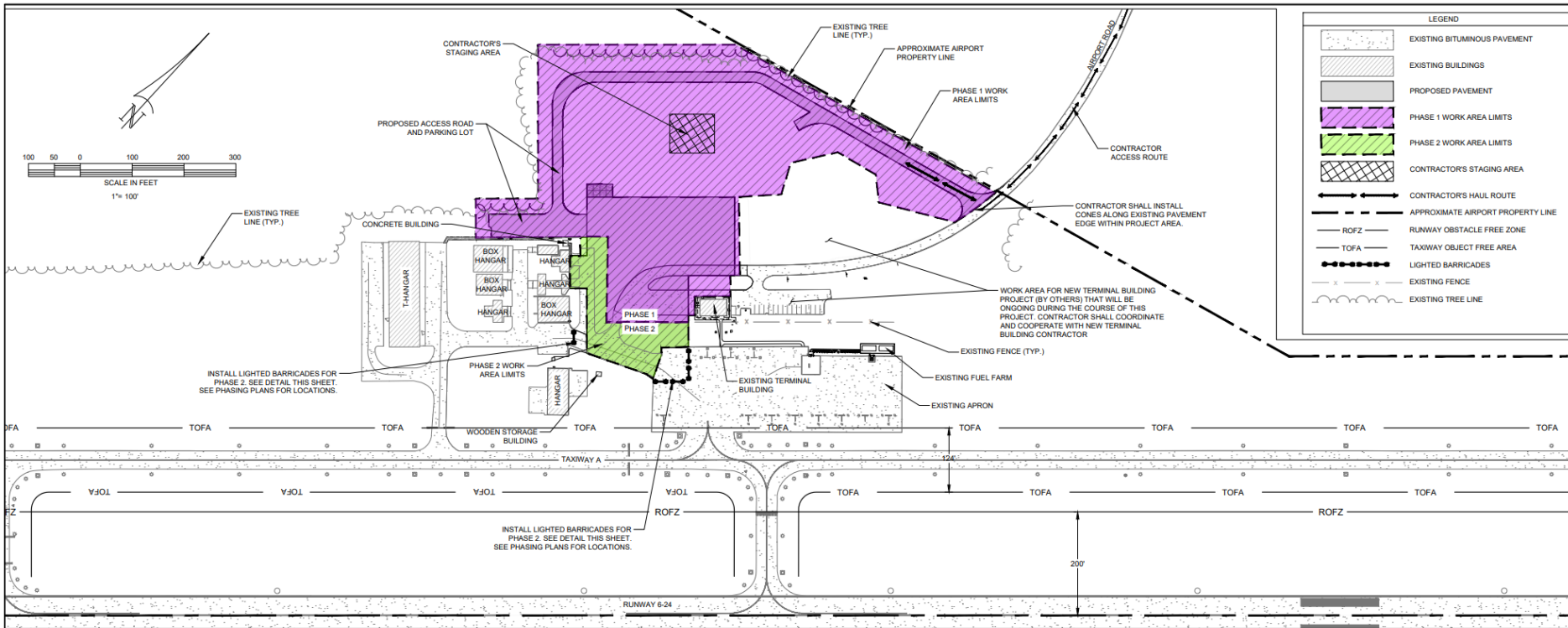

TALBERT & BRIGHT
ENGINEERING & PLANNING CONSULTANTS
4810 SHALLEY DRIVE
WILMINGTON, NC 28405
PHONE: 910-763-3500
FAX: 910-762-4281
EMAIL: TB@TB&B.COM
NC LICENSE NO. C-0713

THIS DRAWING AND THE DESIGN THEREON IS THE PROPERTY OF TALBERT & BRIGHT, INC. NO REPRODUCTION OR USE OF THIS DRAWING OR DESIGN IS PERMITTED WITHOUT THE WRITTEN CONSENT OF TALBERT & BRIGHT, INC.

REV. NO.	DESCRIPTION	DATE

COLUMBUS COUNTY MUNICIPAL AIRPORT
WILMINGTON, NORTH CAROLINA
APRON EXPANSION
PROJECT LAYOUT AND SAFETY PLAN

Project Details:

Work Begin: 07/2024
Est. Completion: 01/2025
Rev. Completion: N/A
Contractor: Highland Paving
NCDOT Contact: Thomas Mann
Contract: \$2,506,918

Project Comments:

Contract time is 180 days.
Notice to proceed 07/29/24.
Erosion control measures, miscellaneous demolition, and directional bore for realignment of airfield lighting completed.
Grading work has started for Phase 1 area.
Project experienced impacts from two inclement weather events.

SAFETY PLAN REQUIREMENTS

THE INTENT OF THIS PLAN IS TO ESTABLISH CERTAIN SAFETY REQUIREMENTS RELATIVE TO AIRPORT OPERATIONS THAT MUST BE STRICTLY ADHERED TO BY THE CONTRACTOR DURING CONSTRUCTION OF THIS PROJECT.

IT IS THE INTENT THAT THE AIRPORT WILL REMAIN OPEN DURING THE DURATION OF THIS PROJECT. TAXILANE CLOSURE WILL BE NECESSARY TO COMPLETE PHASE II WORK ITEMS. TAXILANE CLOSURE SHALL BE CLOSELY COORDINATED WITH AIRPORT MANAGEMENT.

- THE CONTRACTOR SHALL NOT BEGIN WORK WITHIN ANY AIR OPERATIONS AREA WITHOUT APPROVAL OF THE AIRPORT MANAGEMENT. A MINIMUM 72 HOURS NOTICE IS REQUIRED. THE CONTRACTOR AND ENGINEER SHALL COORDINATE CLOSURE SCHEDULE, BARRICADE LOCATIONS, AND PROPOSED AIR OPERATION CONSTRAINTS WITH THE AIRPORT MANAGEMENT FOR THE PROJECT.
- CONTRACTOR WILL NOT BE ALLOWED ON ANY ACTIVE RUNWAY OR TAXIWAY DURING THE CONSTRUCTION OF THIS PROJECT.
- THE CONTRACTOR SHALL COORDINATE INGRESS-EGRESS REQUIREMENTS WITH THE AIRPORT MANAGEMENT.
- ALL CONSTRUCTION VEHICLES, INCLUDING PERSONAL CARS, MUST BE CLEARED FOR ACCESS BY THE AIRPORT MANAGEMENT AND RESIDENT PROJECT REPRESENTATIVE. PERSONAL CARS SHALL BE PARKED OUTSIDE OF THE SECURED AIRFIELD AREAS. ALL VEHICLES OPERATING IN ACTIVE AIR OPERATION AREAS SHALL BE LIGHTED OR FLAGGED IN ACCORDANCE WITH ADVISORY CIRCULAR 150/5370-2G. COPIES OF THE ADVISORY CIRCULAR WILL BE MADE AVAILABLE UPON REQUEST.
- THE CONTRACTOR AND ALL SUBCONTRACTORS SHALL DESIGNATE A LOCAL REPRESENTATIVE AND ALTERNATE TO CONTACT ON A 24 HOUR BASIS IN CASE OF EMERGENCY. IN THE EVENT OF AN EMERGENCY DURING CONSTRUCTION, THE CONTRACTOR SHALL DIAL 911 FOR EMERGENCY RESPONSE PERSONNEL. THE CONTRACTOR SHALL ALSO NOTIFY AIRPORT MANAGEMENT AT (910) 642-6187 ONLY AFTER 911 HAS BEEN CALLED.
- EQUIPMENT AND MATERIALS SHALL NOT BE LEFT ON OR WITHIN 60 FEET OF THE TAXIWAY CENTERLINE OR 55 FEET OF THE TAXILANE CENTERLINE AFTER WORK OPERATIONS ARE CEASED EACH DAY. EQUIPMENT SHALL BE RETURNED TO THE STAGING AREA EACH NIGHT UNLESS APPROVED OTHERWISE BY AIRPORT MANAGEMENT.
- PRIOR TO COMMENCING CONSTRUCTION ACTIVITIES, THE CONTRACTOR SHALL LOCATE ALL EXISTING UTILITIES WITHIN PROJECT WORK AREAS. THIS EFFORT SHALL INCLUDE COORDINATING WITH LOCAL UTILITY CONTACTS. THE CONTRACTOR SHALL LOCATE AND PROTECT ALL EXISTING UTILITIES AND SHALL BE RESPONSIBLE FOR THE IMMEDIATE RESOLUTION AND REPAIR OF ANY UTILITY FACILITIES DAMAGED IN THE COURSE OF CONTRACTORS OPERATIONS.

- THE CONTRACTOR SHALL COORDINATE WITH THE AIRPORT MANAGEMENT WHEN WORKING ON AIRPORT PROPERTY.
CONTACT: PHIL EDWARDS AIRPORT MANAGER (910) 642-6187
- THE CONTRACTOR SHALL COMPLY WITH ALL APPLICABLE FEDERAL, STATE, AND LOCAL REGULATIONS IN REGARD TO CONSTRUCTION NOISE AND EROSION CONTROL DURING CONSTRUCTION.
- THE CONTRACTOR SHALL KEEP ALL AIRFIELD PAVEMENTS AND CONSTRUCTION AREAS CLEAN OF LITTER, LOOSE PAPERS, DEBRIS, ETC. ON A DAILY BASIS, OR AS DIRECTED BY THE AIRPORT MANAGEMENT AND/OR ENGINEER. ALL SPILLAGE ON PAVED AREAS SHALL BE CLEANED UP IMMEDIATELY.
- WHEN CONSTRUCTION IS BEING ACCOMPLISHED ADJACENT TO AN ACTIVE RUNWAY, TAXIWAY, OR APRON, EQUIPMENT SHALL BE OBSTRUCTION-MARKED AND LIGHTED IN ACCORDANCE WITH ADVISORY CIRCULAR 150/5370-2G AND 150/5210-5D. COPIES OF THE ADVISORY CIRCULARS WILL BE MADE AVAILABLE UPON REQUEST.
- THE CONTRACTOR SHALL COORDINATE ACCESS ROUTE TO CONSTRUCTION AREAS WITH THE ENGINEER AND THE AIRPORT MANAGEMENT PRIOR TO BEGINNING WORK.
- OPEN TRENCHES, EXCAVATION, DROP-OFFS, AND STOCKPILED MATERIAL WILL NOT BE PERMITTED WITHIN 60 FEET OF THE CENTERLINE OF ACTIVE TAXIWAY OR WITHIN 55 FEET OF THE CENTERLINE OF ACTIVE TAXILANE. COVERINGS FOR OPEN TRENCHES MUST BE OF SUCH STRENGTH TO SUPPORT CRITICAL VEHICLE AS DETERMINED BY THE ENGINEER AND AIRPORT MANAGEMENT.
- INSPECTION - INSPECTIONS MUST BE MADE BY THE AIRPORT MANAGEMENT DURING ALL PHASES OF THE WORK TO ENSURE THAT THE CONTRACTOR IS FOLLOWING RECOMMENDED SAFETY PLAN PROCEDURES IN THE OPERATION AREA.

NOTAMS
AIRPORT MANAGEMENT WILL ISSUE THE NECESSARY NOTAMS TO REFLECT HAZARDOUS CONDITIONS. IT IS IMPORTANT THAT NOTAMS BE KEPT CURRENT AND REFLECT THE ACTUAL CONDITIONS WITH RESPECT TO CONSTRUCTION SITUATIONS. ACTIVE NOTAMS SHALL BE REVIEWED PERIODICALLY AND REVISED TO REFLECT THE CURRENT CONDITIONS.

CONSTRUCTION CONTRACTORS RESPONSIBILITIES:

- CONTRACTOR SHALL SUBMIT SAFETY PLAN COMPLIANCE DOCUMENT (SPCD) TO THE ENGINEER ON HOW CONTRACTOR SHALL COMPLY WITH THE SAFETY PLAN REQUIREMENTS FOR THE PROJECT.
- CONTRACTOR SHALL HAVE AVAILABLE A COPY OF THE PROJECT AIRPORT SAFETY PLAN ON SITE AT ALL TIMES.
- CONTRACTOR SHALL COMPLY WITH THE AIRPORT SAFETY PLAN ASSOCIATED WITH THE CONSTRUCTION PROJECT AND ENSURE THAT CONSTRUCTION PERSONNEL ARE FAMILIAR WITH SAFETY PROCEDURES AND REGULATIONS ON THE AIRPORT.
- CONTRACTOR SHALL PROVIDE A POINT OF CONTACT WHO WILL COORDINATE AN IMMEDIATE RESPONSE TO CORRECT ANY CONSTRUCTION-RELATED ACTIVITY THAT ADVERSELY AFFECT THE OPERATIONAL SAFETY OF THE AIRPORT.
- CONTRACTOR SHALL PROVIDE A SAFETY/CONSTRUCTION INSPECTOR FAMILIAR WITH AIRPORT SAFETY TO MONITOR CONSTRUCTION ACTIVITIES.
- CONTRACTOR SHALL RESTRICT MOVEMENT OF CONSTRUCTION VEHICLES TO CONSTRUCTION AREAS BY FLAGGING AND BARRICADING, OR ERECTING TEMPORARY FENCING, AS APPROPRIATE. CONTRACTOR SHALL NOT BE ALLOWED TO ACCESS ACTIVE AIR OPERATIONS AREAS.
- CONTRACTOR SHALL ENSURE THAT NO CONTRACTORS EMPLOYEES, EMPLOYEES OF SUBCONTRACTORS OR SUPPLIERS, OR OTHER PERSONS ENTER ANY PART OF THE AIR OPERATIONS AREAS (AOA) FROM THE CONSTRUCTION SITE UNLESS AUTHORIZED AND APPROVED BY AIRPORT MANAGEMENT.

STAGING AND STOCKPILING NOTES

- CONTRACTOR SHALL SET UP STAGING AND STOCKPILE AT LOCATIONS SHOWN ON THIS SHEET OR AS AUTHORIZED BY THE ENGINEER.
- THE CONTRACTOR SHALL ACCESS THE CONSTRUCTION SITE FROM AIRPORT ROAD AS DEPICTED ON THE PLANS. SEE ALSO PROJECT SPECIAL PROVISIONS FOR CONSTRUCTION ACCESS ROUTE. CONTRACTOR SHALL COORDINATE INGRESS/EGRESS WITH THE RPR AND AIRPORT MANAGEMENT. CONSTRUCTION STAGING AND STOCKPILE AREA SHALL BE AS DEPICTED ON THIS PLAN SHEET. ALL WORK AND MATERIALS REQUIRED TO PROVIDE ACCESS TO THE PROJECT SITE SHALL BE INCLUDED IN COST FOR ITEM "TEMPORARY CONSTRUCTION ITEMS".

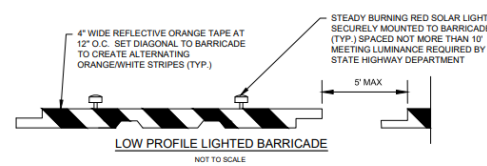

AVIATION BARRICADE NOTES:

- THE CONTRACTOR IS RESPONSIBLE FOR PROVIDING AND MAINTAINING AVIATION BARRICADES IN SUFFICIENT QUANTITIES TO COMPLETE THE WORK FOR THIS CONTRACT. PAYMENT FOR LOW PROFILE LIGHTED BARRICADES SHALL BE INCLUDED IN ITEM "TEMPORARY CONSTRUCTION ITEMS".
- LOW PROFILE LIGHTED BARRICADES SHALL BE MULTI-BARRIER AIRPORT RUNWAY BARRICADE AR1006 AND SOLAR LIGHTS SHALL BE PROVIDED FOR THE BARRICADES AS MANUFACTURED BY OFF THE WALL PRODUCTS, LLC OR APPROVED EQUAL. THE CONTRACTOR SHALL PROVIDE WATER NECESSARY TO FILL THE BARRICADES AND ENSURE ADEQUATE WATER HAS BEEN PROVIDED TO ANCHOR THE BARRICADES IN PLACE.
- CONTRACTOR SHALL CHECK LIGHTS DAILY TO VERIFY THAT THEY ARE IN WORKING CONDITION AND SHALL REPLACE LIGHTS AS REQUIRED.
- CONTRACTOR SHALL INSTALL BARRICADES AT LOCATIONS SHOWN ON INDIVIDUAL PLAN SHEETS. BARRICADES SHALL BE MOVED AND RELOCATED AS REQUIRED. BARRICADES SHALL BE INSTALLED WITH MAXIMUM 5' SPACE BETWEEN BARRICADE AND CONTRACTOR SHALL LEAVE ONE 18" SPACE FOR EMERGENCY VEHICLES AS DETERMINED BY AIRPORT. PROVIDE HOLD DOWN AND LATERAL SUPPORT TO PREVENT OVERTURNING FROM PROP WASH AND JET BLAST.

FINAL DRAWING - NOT RELEASED FOR CONSTRUCTION

Date: JANUARY 2024
Scale: 1" = 100'
Drawn: PCC/AE
Checked: JMM
Project No.: 2206-2201
Sheet No.: A2

CONSTRUCTION PROGRESS

25%

09/30/2024

NCDOT, Division 6 - HMIP (Active)

Contract	Project	Contractor	Let	Completion	Progress	Project Cost	County
DF00441	Concrete installations in Division 6 (curb ramps)	Morgan Trucking & GC	09/2023	10/2025	47% 09/07/2024	\$2,530,730	Bladen, Cumberland, Harnett, & Robeson
DF00455	Resurfacing, widening & pavement markings on 3 routes totaling 5.94 miles	Highland Paving	11/2023	06/2025	27% 07/07/2024	\$890,460	Bladen & Columbus
DF00466	AST (double & triple seals) on 20 SR's totaling 43.59 miles	Riley Paving	02/2024	09/2025	0% 09/16/2024	\$1,385,522	Columbus
DF00467	Resurfacing, milling, & pavement markings along 9 routes totaling 11.84 miles.	Barnhill	02/2024	09/2025	55% 08/31/2024	\$3,238,619	Columbus
DF00468	Resurfacing, milling, & pavement markings along 3 routes totaling 13.6 miles.	Highland Paving	02/2024	09/2025	0% 09/20/2024	\$2,675,069	Columbus
DF00477	Permanent raised pavement marker installations on 1,244.14 miles of roadway	WL Markers Inc.	04/2024	11/2024	0% 09/20/2024	\$333,702	Bladen, Columbus, Cumberland, Harnett, & Robeson
D6D3.PO C.027	On-call Hot Poured Rubber Asphalt Joint Sealer	TBD	07/2024	08/2024	0%	TBD	Bladen & Columbus
DF00487	Widening, resurfacing, milling & pavement markings along 3 routes totaling 12.9 miles.	Barnhill	09/2024	04/2026	0%	\$3,391,389	Columbus



NCDOT, Division 6 - HMIP & Safety Projects (Future)

TIP/WBS	County	Project	R/W	Let	Est. Cost
HI-0018	Columbus	US 74 (Future I-74), from west of US 701 Business to west of NC 214 - Pavement Rehabilitation.	N/A	02/2025	\$32,900,000
HS-2406A	Columbus	NC 87, install rumble stripes, LLPM's and RPM's from MM 1.033 to MM 6.933.	N/A	02/2025	\$290,000
HS-2406G	Bladen, Columbus	US 701, install rumble stripes and LLPM for 10.38 miles (MM 19.97 to MM 30.35) in Columbus County and 12.91 miles in Bladen County (MM 2.57 to MM 15.48).	N/A	02/2025	\$1,000,000
HS-2406J	Columbus	NC 130 install rumble stripes and LLPM for 17.04 miles (MM 0 to MM 17.05); and NC 410 for 10.98 miles (MM 2.62 to MM 13.6)	N/A	02/2025	\$890,000
HS-2406I	Bladen, Columbus, Cumberland	Upgrade 60 guardrail end units along various routes.	N/A	03/2025	\$609,000
BP6-R008	Columbus	SR 1818 (Neils Eddy Road) – Replace bridge #271 over Mill Creek.	FY 2023	09/2025	\$1,180,000
HN-0023	Columbus	US 701 Bus. (Madison Street), SR 1916 (Lee Street) and SR 1953 (Franklin Street) – Construct roundabout to replace existing traffic signal.	FY 2025	02/2026	\$3,500,000
BP6-R013	Columbus	SR 1158 (Chair Factory Road) - Replace bridge #324 over Beaver Dam Swamp.	FY 2025	FY 2028	\$2,145,000
HI-0020	Columbus	US 74 (Future I-74), from Robeson County Line to west of SR 1585 (Union Valley Road) – Pavement Rehabilitation.	N/A	02/2029	\$15,300,000
HI-0019	Columbus	US 74 (Future I-74), from west of SR 1585 (Union Valley Road) to west of US 701 Business – Pavement Rehabilitation.	N/A	03/2029	\$5,700,000
HB-0009	Columbus	SR 1800 (Blacksmith Road) – Replace bridge #230250 over Ricefield Branch.	FY 2029	01/2030	\$850,000
06-24-73565	Columbus	NC 410 (Brown Street) at First Avenue.	N/A	N/A	\$100,000
SS-6206AO	Columbus	NC 131 at SR 1005 (Peacock Road) – Convert to All-Way Stop.	N/A	N/A	\$34,000

Note: Projects details are subject to change

NCDOT, Division 6 – Roadway Projects (Future)

TIP / WBS	County	Project	R/W	Let	Est. Cost
R-5020A	Columbus	US 701 Bypass, b/w south of SR 1166 (Pleasant Plains Road) and SR 1437 (Virgil Avenue) – Widen to multi-lanes (Whiteville area)	FY 2018	07/2029	\$54,300,000
I-6011A	Columbus	I-74 . US 74 at SR 2225 (Creek Road)	01/2025	01/2027	\$8,640,000
R-2561B	Columbus	NC 87, from SR 1730 (Elwell Ferry Road) in Bladen Co. to NC 11 in Columbus Co. – widening to multi-lanes	TBD	TBD	\$126,500,000
R-2561C	Columbus	NC 87, from NC 11 to US 74 / US 76 – widen to multi-lanes	TBD	TBD	\$117,501,000
I-6011	Columbus	I-74 / US 74, from NC 41 near Lumberton to US 76 near Chadbourn – upgrade US 74 to interstate standards	TBD	TBD	\$175,845,000

NCDOT, Division 6 - LAP Projects (Future)

TIP / WBS	County	Project	R/W	Let	Est. Cost
BN-0006	Columbus	US 701 Business, from Jessie Street to Lynwood Norris Road – Construct Sidewalk	FY 2024	05/2027	\$250,000





STATE OF NORTH CAROLINA
DEPARTMENT OF TRANSPORTATION

ROY COOPER
GOVERNOR

J.R. "JOEY" HOPKINS
SECRETARY

October 2024

Nazia Sarder
Transportation Engineer
NCDOT Transportation Planning Division
1 South Wilmington Street
Raleigh, NC 27601

OCTOBER TPD UPDATES CAPE FEAR RPO

OCTOBER 2024

Brunswick County Comprehensive Transportation Plan (CTP): The CTP is now complete and has been adopted and endorsed by all local agencies as well as the NCDOT Board of Transportation.

Columbus County Comprehensive Transportation Plan (CTP): The draft CTP recommendations maps and draft report are under management review. After internal review is completed, draft maps and report will be sent to locals for their review. After all reviews are complete and necessary changes are made, the CTP will go for local and NCDOT adoptions.

Pender County Comprehensive Transportation Plan (CTP): The Pender County CTP survey closed on September 1st, the CTP committee has not met for a few months because the engineer was on leave. Now that the engineer is back, the CTP will resume in the coming weeks.

Wilmington Travel Demand Model (TDM): the TDM is ready for MPO project testing and will be official when the MPO adopts their MTP end of 2025.

Additional information: The Census is available on the United States Census Bureau site. Refer to the [website](#) for census information.

Helpful Links:

Click on links below to learn more:

- NCDOT home page—[ncdot.gov](https://www.ncdot.gov)
- Real-Time Traffic—DriveNC.gov | [North Carolina Traffic & Travel Information](#)
- Report a pothole—[NCDOT Contact Us Form](#)
- NCDOT: State Transportation Improvement Program— [ncdot.gov/sti](https://www.ncdot.gov/sti)

Mailing Address:
NC DEPARTMENT OF TRANSPORTATION
BUSINESS UNIT NAME
ADDRESS 1
CITY, NC ZIP

Telephone: ###-###-####
Fax: ###-###-####
Customer Service: 1-877-368-4968

Location:
ADDRESS 2
CITY, NC ZIP

Website: [ncdot.gov](https://www.ncdot.gov)

- Interactive Bicycle Routes Map—<https://www.ncdot.gov/bikeped/ncbikeways/default.aspx>
- Links to all traffic count data information—[Traffic Survey Group \(ncdot.gov\)](#)
- NCDOT Interactive Traffic Volume Map—[Interactive Traffic Volume map \(ncdot.gov\)](#)
- Traffic Safety Data & Engineering—[NCDOT: Traffic Safety Data & Engineering](#)

NCDOT Statewide Plans:

To learn more, click on the following links:

- [NC Moves 2050 Plan](#) (or go to ncdot.gov/ncmoves)
- [NCDOT Strategic Transportation Corridors](#) (or go to ncdot.gov and search: Strategic Transportation Corridors)
- [NCDOT Comprehensive State Rail Plan \(25-Year Vision\)](#) (or go to ncdot.gov and search: rail plan)
- [NC Statewide Multimodal Freight Plan \(2015-2040\)](#) (or go to ncdot.gov and search: public transportation plan)
- [NCDOT Resilience Strategy Report \(2021\)](#) (or go to ncdot.gov and search: resilience strategy report)
- [Statewide Pedestrian & Bicycle Plan \(2013\)](#) (or go to ncdot.gov/bikeped/walkbikenc)

The Cape Fear Rural Transportation Planning Organization serves as the intergovernmental organization for local elected officials, the North Carolina Department of Transportation, and residents of Brunswick, Columbus and Pender Counties to work cooperatively to address transportation issues.

Transportation Acronyms *(Updated Sept. 2024)*

AADT	Annual Average Daily Traffic
ADA	Americans with Disabilities Act (1990)
BOT	Board of Transportation (NCDOT)
CTP	Comprehensive Transportation Plan
EIS	Environmental Impact Statement
FAA	Federal Aviation Administration
FHWA	Federal Highway Administration
FRA	Federal Railroad Administration
FTA	Federal Transit Administration
GIS	Geographic Information System
HSIP	Highway Safety Improvement Program
ITRE	Institute for Transportation Research and Education (NC State)
LIP	Local Input Points
LOS	Level of Service
MPO	Metropolitan Planning Organization
NCAMPO	North Carolina Association of Metropolitan Planning Organizations
NCARPO	North Carolina Association of Rural Planning Organizations
NCDOT	North Carolina Department of Transportation
NEPA	National Environmental Policy Act (1969)
PWP	Planning Work Program

ROW	Right of Way
RPO	Rural Planning Organization
SPOT	Strategic Prioritization Office of Transportation (NCDOT)
STI	Strategic Transportation Investments Law (2013)
STIP	State Transportation Improvement Program
TAC	Transportation Advisory Committee (Local Elected Officials)
TCC	Technical Coordinating Committee (Local Staff)
TIA	Transportation Impact Analysis
TOD	Transit Oriented Development
TPD	Transportation Planning Division (NCDOT)
USDOT	United State Department of Transportation
VMT	Vehicle Miles Traveled